

### Package List

<b>1</b> 1×MDF Spoilboard (300mm*180mm*12mm)	<b>2</b> 1×Hexagon Socket Wrench (3mm)	<b>3</b> 7×Screw (M5*16)	<b>4</b> 7×Slider Nut (M5)	<b>5</b> 1×Assembly Guide
				

### Assembly Instructions

- Place the 6 pieces of M5 slider nuts into the recess of the aluminum plate, and then place the MDF spoilboard on top of the aluminum plate.
- Adjust the M5 slider nuts position so that the center of the slider nut hole and the center of the corresponding countersunk hole on the MDF spoilboard are concentric.
- Thread 6 pieces of M5\*16 screws into the countersunk holes of the MDF spoilboard and screw the corresponding slider nuts for 3-4 turns.
- Align the MDF spoilboard with the aluminum plate all around, then tighten all the M5\*16 screws.

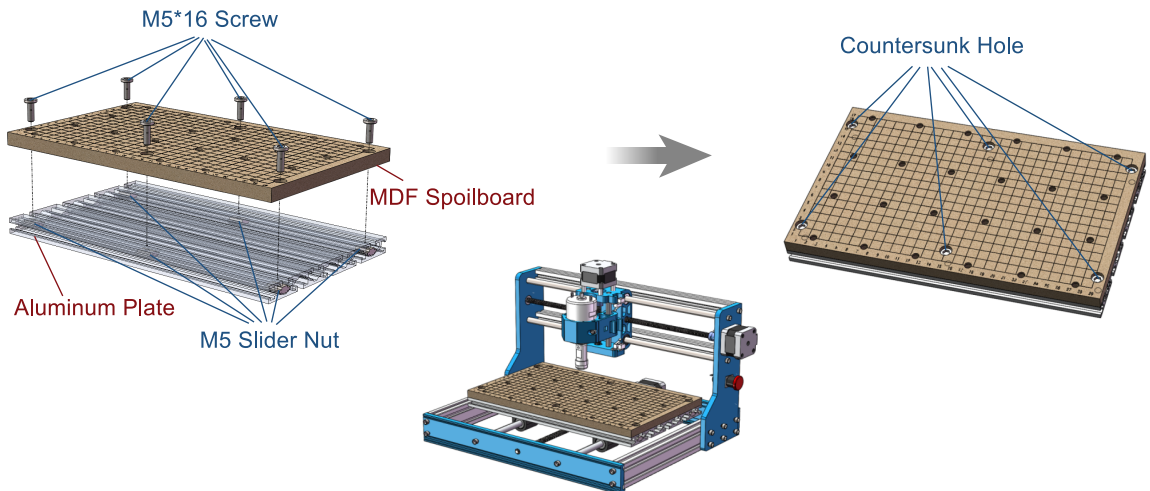

For technical support, please email us via [support@sainsmart.com](mailto:support@sainsmart.com)  
 Help and support is also available from our Facebook group  
 (SainSmart Genmitsu CNC Users Group)

