

Genmitsu

INSTALLATION GUIDE

4040 Reno Extension Kit Installation Guide

V1.0 Aug 2024



Contents

Welcome	01
PART 1: X-axis Extension Module	06
Remove the X-axis module	07
Install the X-axis Extension Module	21
PART 2: Y-axis Extension Module	41
Remove the Y-axis module	42
Install the Y-axis Extension Module	62
PART 3: Install the Hybrid Spoilboard	89
Install the 4040 Hybrid Spoilboard	91
Install the 6040 Hybrid Spoilboard	96
Install the 4080 Hybrid Spoilboard	102
Install the 6080 Hybrid Spoilboard	106



Welcome

Thank you for purchasing the Genmitsu 4040 Reno CNC Router Extension Kit from SainSmart.

For technical support, please email us at support@sainsmart.com.

Help and support is also available from our Facebook group. (SainSmart Genmitsu CNC Users Group)

Scan QR code to find information.



Scan To Find
CNC Resource



Scan QR code
to join the group

Das deutschsprachige Handbuch kann durch Scannen des folgenden QR-Codes aufgerufen werden

日本語マニュアルは以下のQRコードをスキャンして入手できます



Deutsche Anleitung
日本語説明書



Welcome

This manual contains installation instructions for the hybrid spoilboard, and the MDF spoilboard installation instructions can be found in the corresponding manuals.

In order for you to have a better experience, please make sure to inventory the materials first and read the installation manual carefully before installing. Please select the installation steps according to your needs.

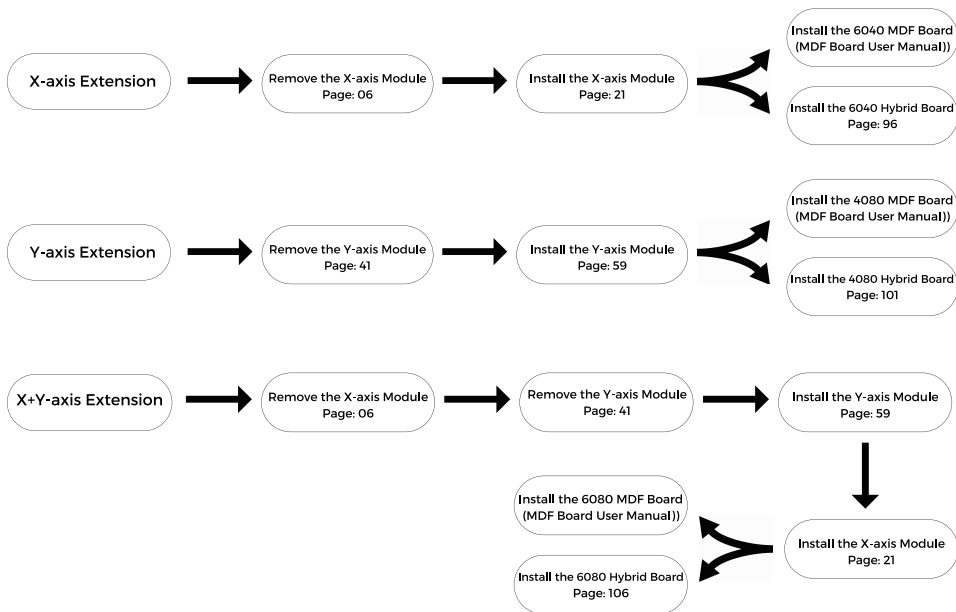



Welcome

6040 Reno

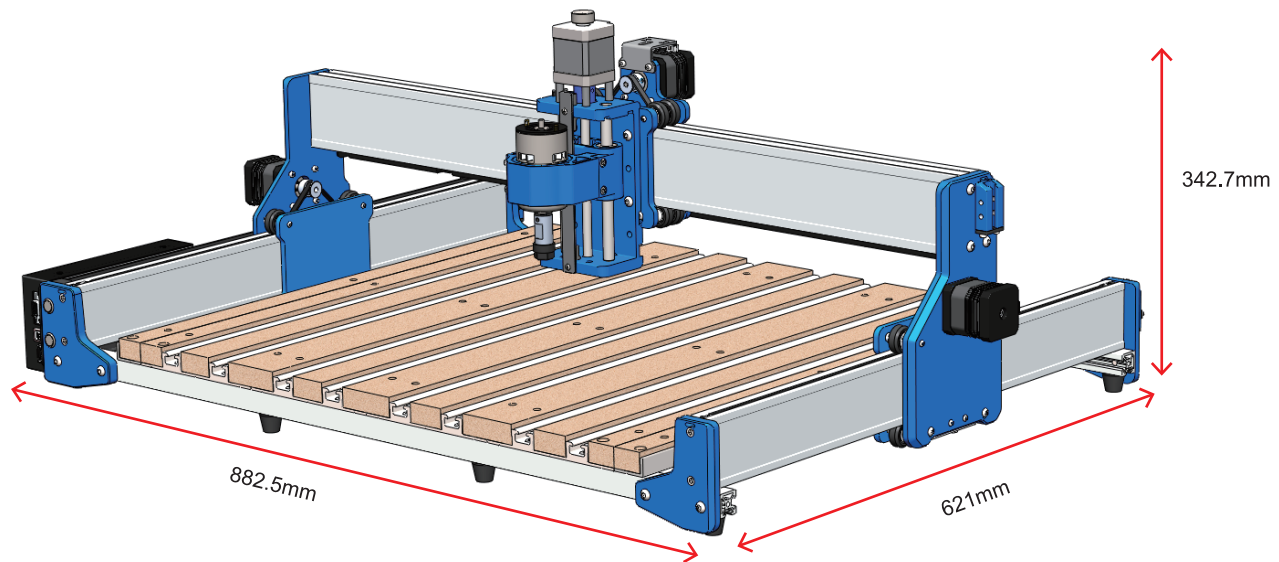



Welcome

4080 Reno

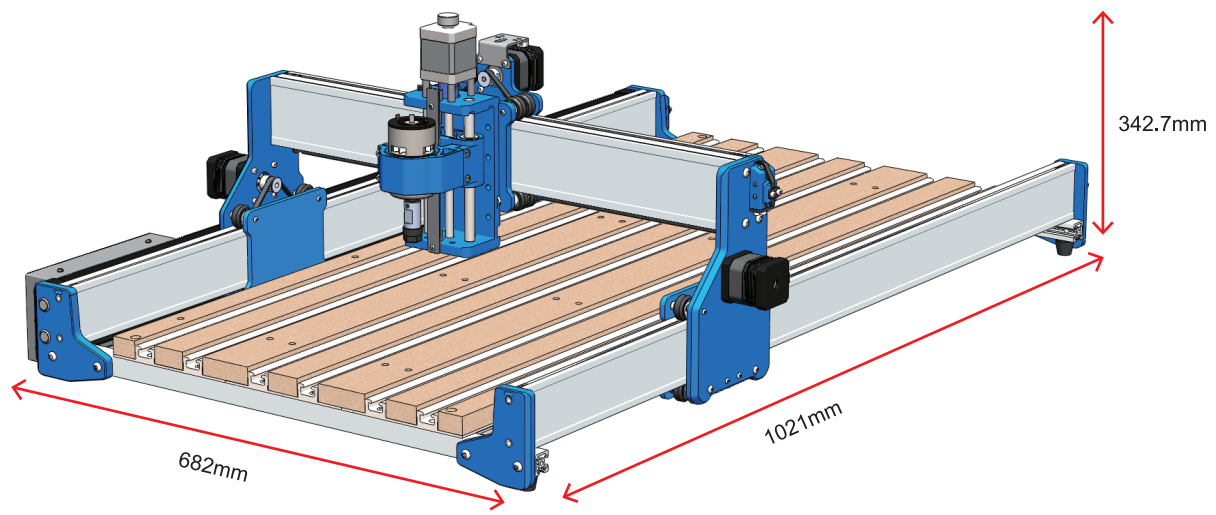



Welcome

6080 Reno

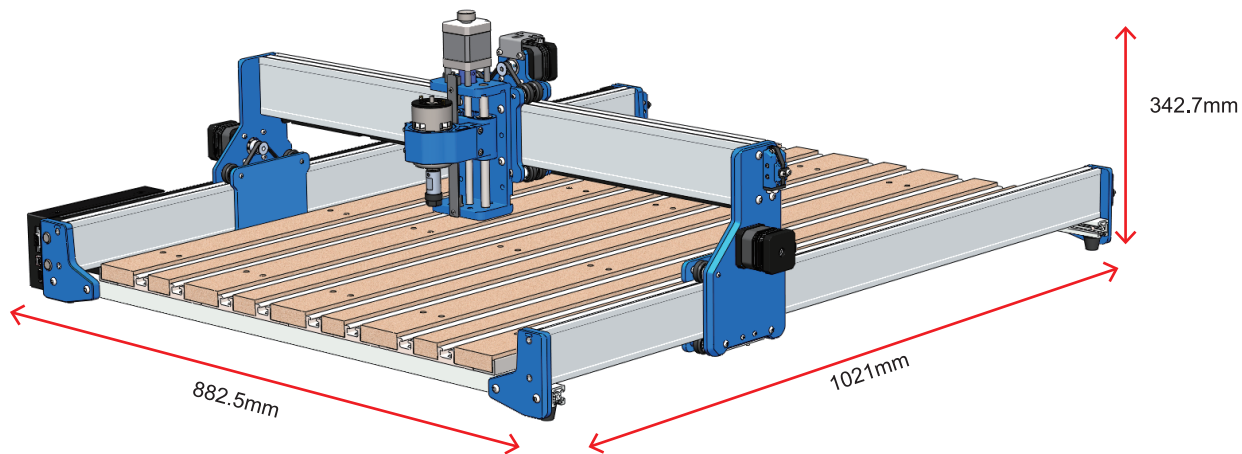

PART 1: X-axis Extension Module



Remove the X-axis module

Step 1: Disconnect Cables

Gently disconnect and remove all the cables connected.

Tip: Note how and where each cable is connected for easy reconnection later.

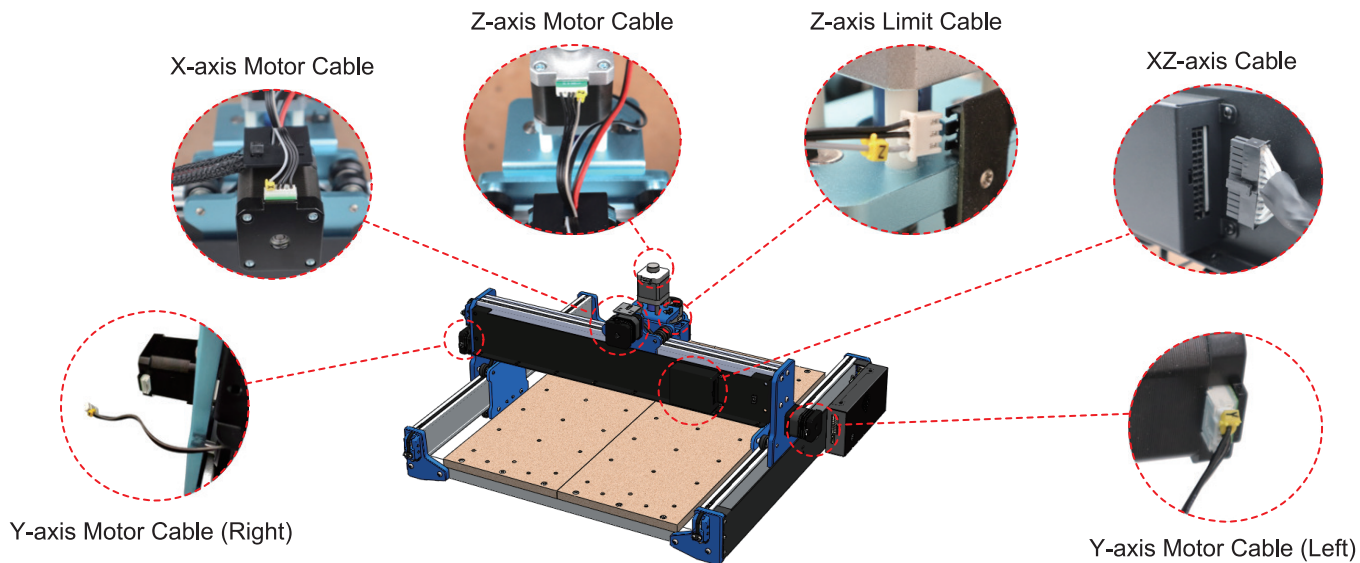

Remove the X-axis module

Step 2: Remove the X-axis Module

1. Loosen the belt tensioner screws and pull out the end of the belt.

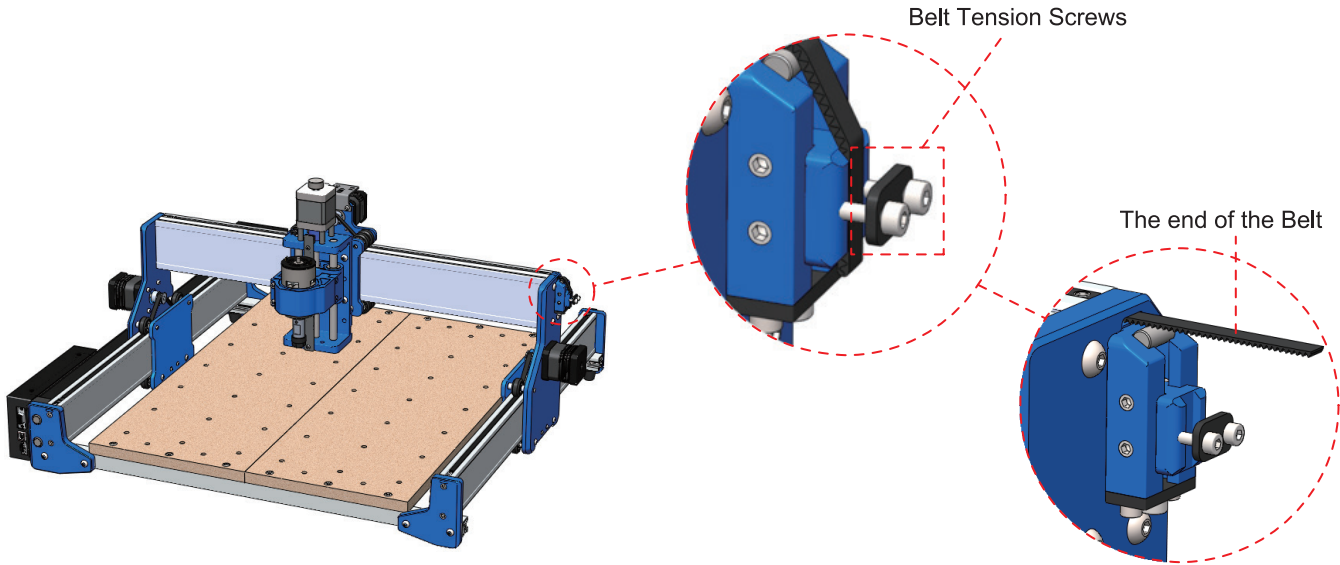

Remove the X-axis module

2. Loosen the (4) tightening screws, then remove the isolation column (dowel pin) and belt tensioner slider block.
3. Unscrew and remove the slider locating screw.

Remember to Keep: belt tensioner slider block, tightening screws and slider locating screw.

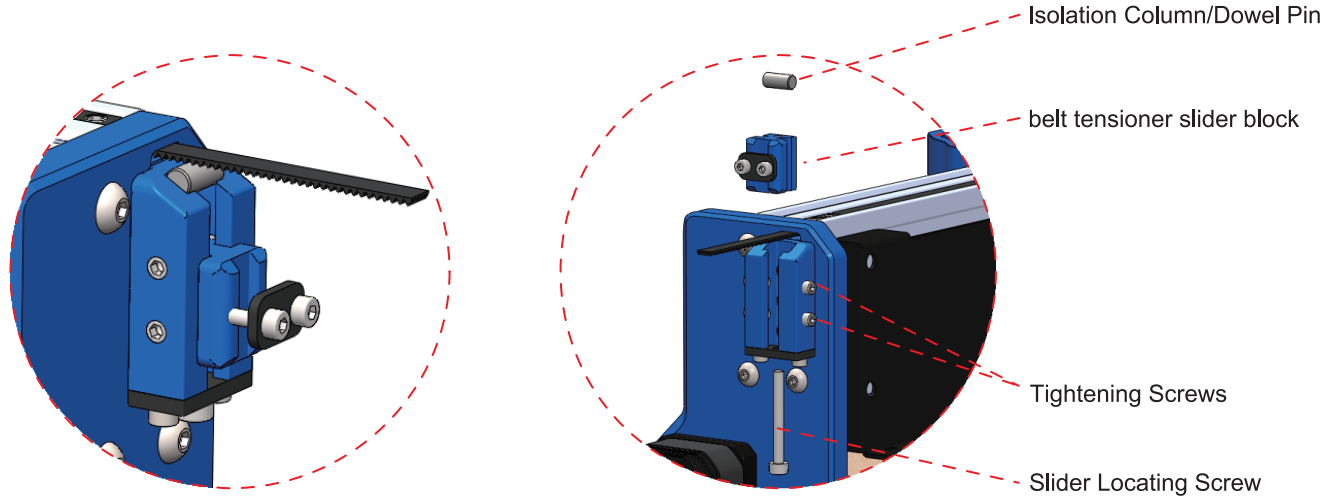

Remove the X-axis module

4. Unscrew the (3) hex socket flat head cap screws on the belt tensioner holder, and removed the belt tension holder.

Remember to Keep: belt tensioner holder.

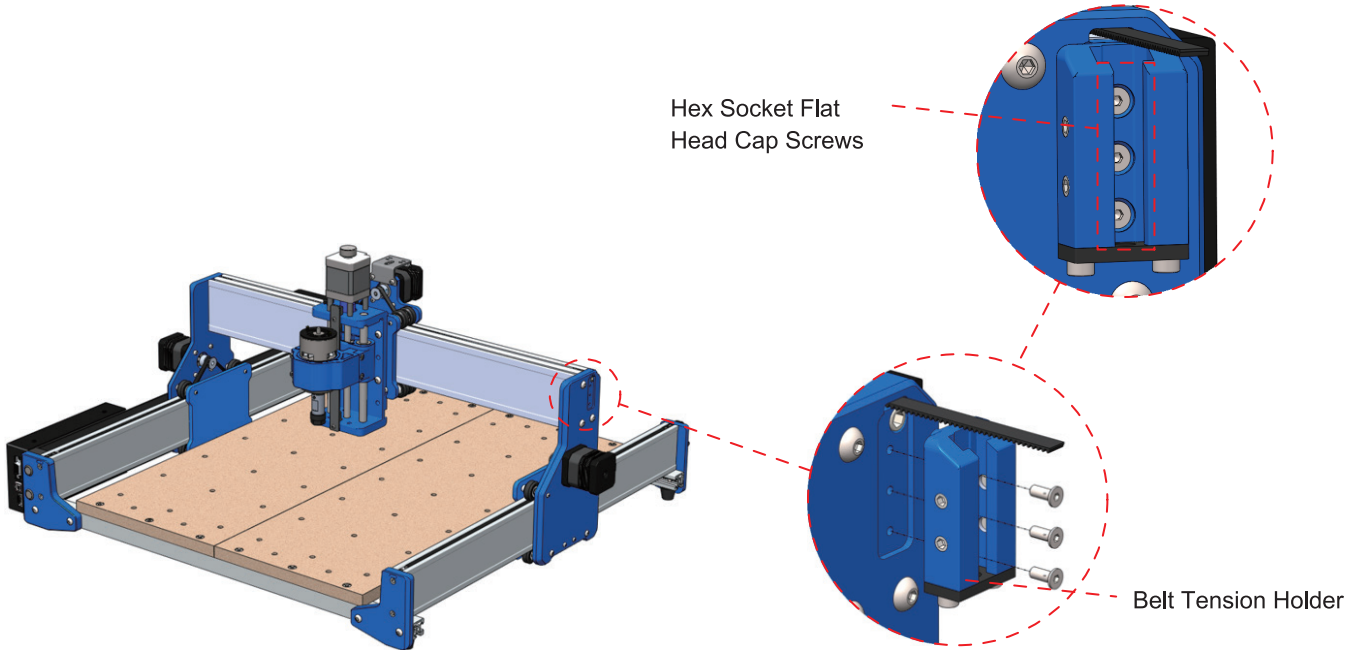

Remove the X-axis module

5. Unscrew the (2) X-axis compression belt screws at the XY-axis vertical plate on the side of the belt tensioner as shown, and pull the belt out of the riser here. (Not pulling out the belt will make subsequent removal of the XZ module more laborious.)

The X-axis Compression Belt Screws

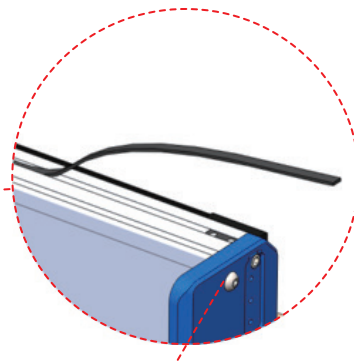
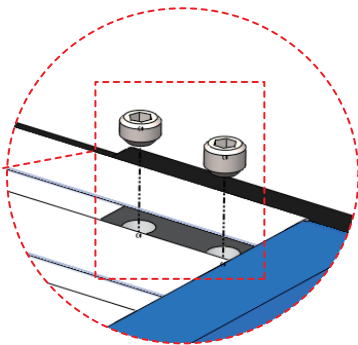

XY-axis Vertical Plate

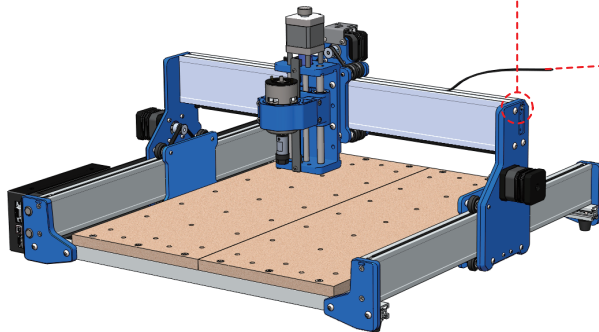

Remove the X-axis module

6. Unscrew (7) M5 rounded hex screws and (1) M5 Small Socket Head Cap Screw at the two XY-axis vertical plates, followed by carefully removing the X-Z module.

(4) M5 Rounded Hex Screw

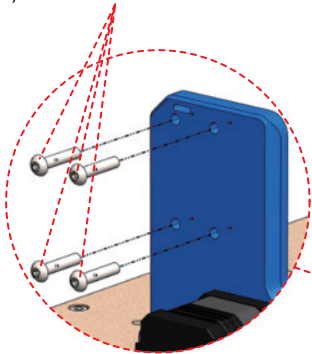

(3) M5 Rounded Hex Screw

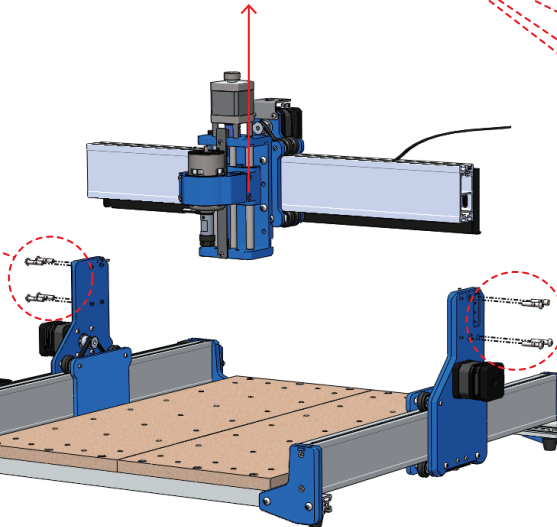

M5 Small Socket Head Cap Screw

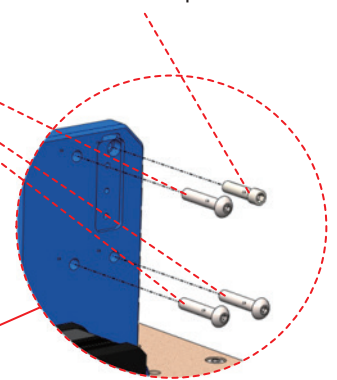



Remove the X-axis module

7. Remove the X-axis belt from the sliding module, and remove the belt lever.

Remember to Keep: belt lever.

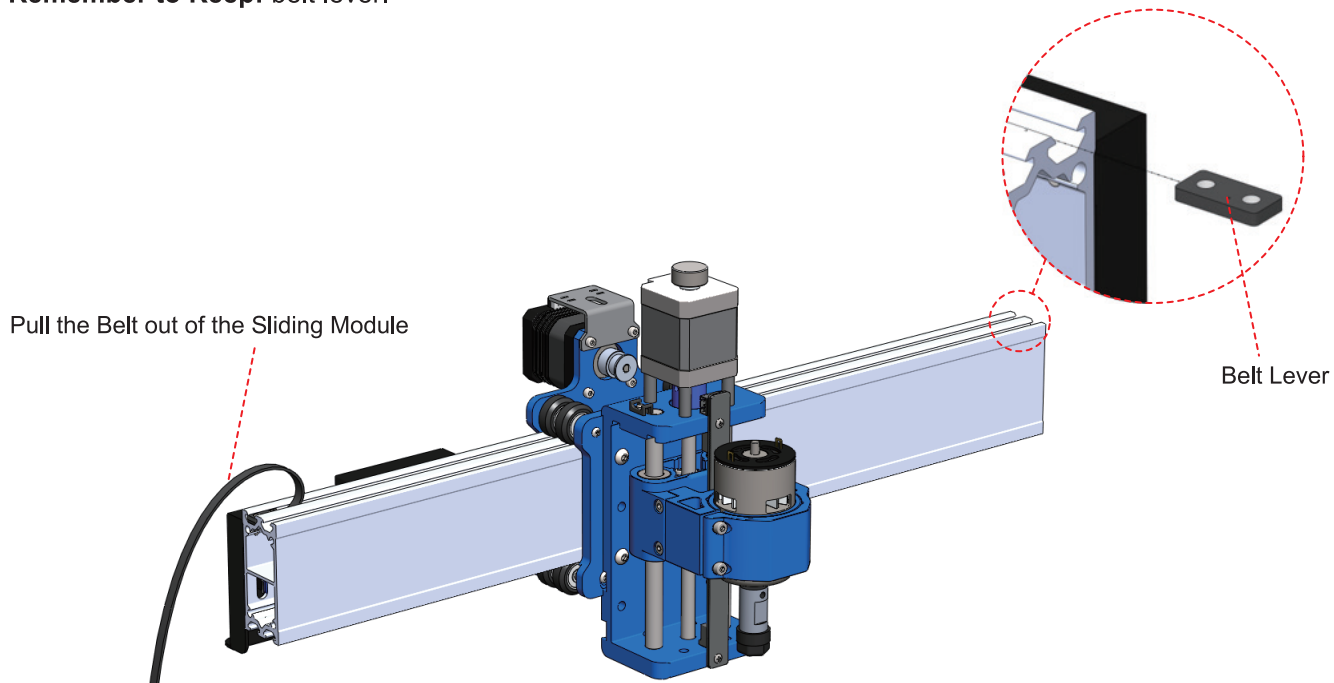

Remove the X-axis module

8. Remove the X-axis Control Board.

8.1 Unscrew the (4) M3 round head socket screws from the sheet metal housing, remove the sheet metal housing.

8.2 Cut the cable fixing ties and remove the cables from the circuit board. One of the cables connects to the left motor of the Y-axis (as shown) and needs to be retained.

8.3 Unscrew the (4) round head Phillips screws securing the circuit board, and remove the circuit board.

Remember to Keep: sheet metal housing and circuit board.

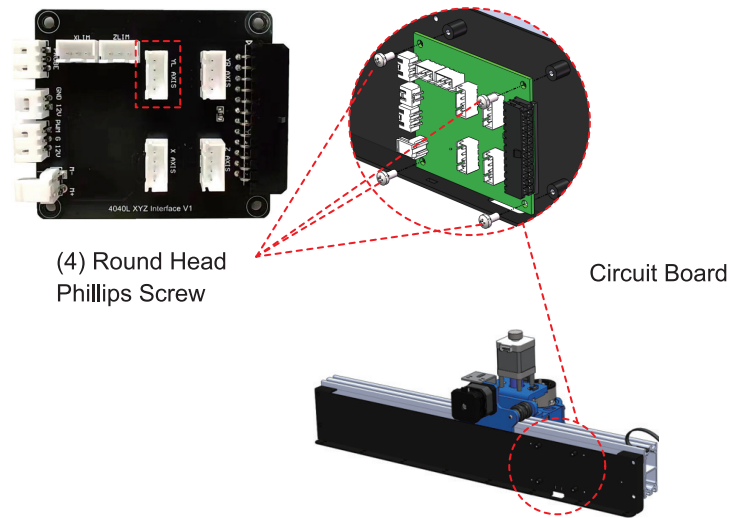
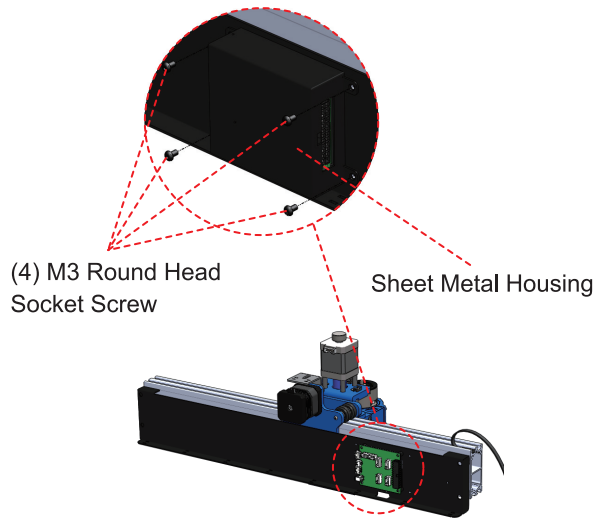

Remove the X-axis module

9. Unscrew the (4) M3 cup head socket screws and remove the sheet metal backplate.

10. Unscrew the (4) round head Phillips screws and remove the (2) limit switches.

Remember to Keep: limit switches.

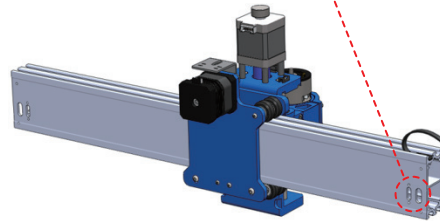
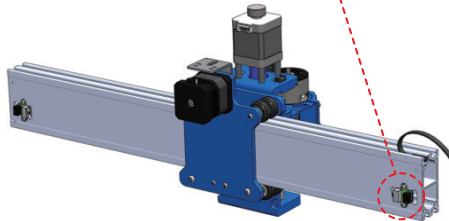
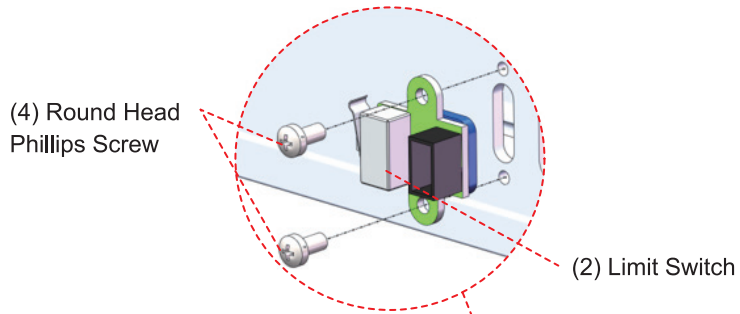
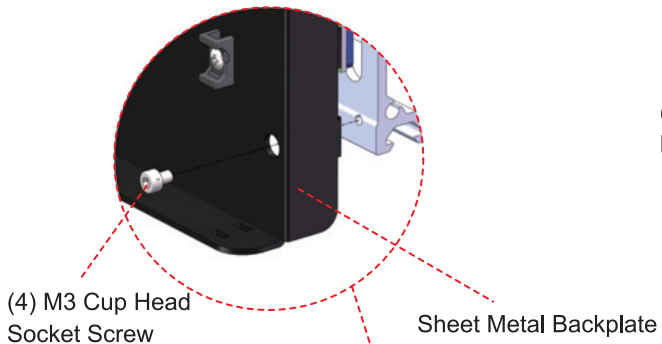



Remove the X-axis module

11. Slide the XZ-axis assembly out of the X-axis custom profile.

Remember to Keep: XZ-axis assembly.

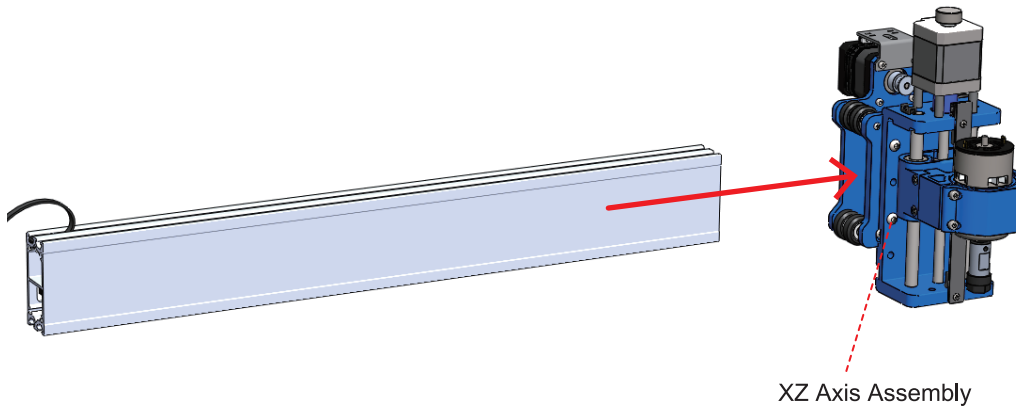

XZ Axis Assembly



Remove the X-axis module

Step 3: Remove the Y-axis Module Platform and MDF Board

1. Unscrew the (12) M5 cup head socket screws and remove the (2) MDF boards.

Remember to Keep: M5 cup head socket screws and MDF boards.

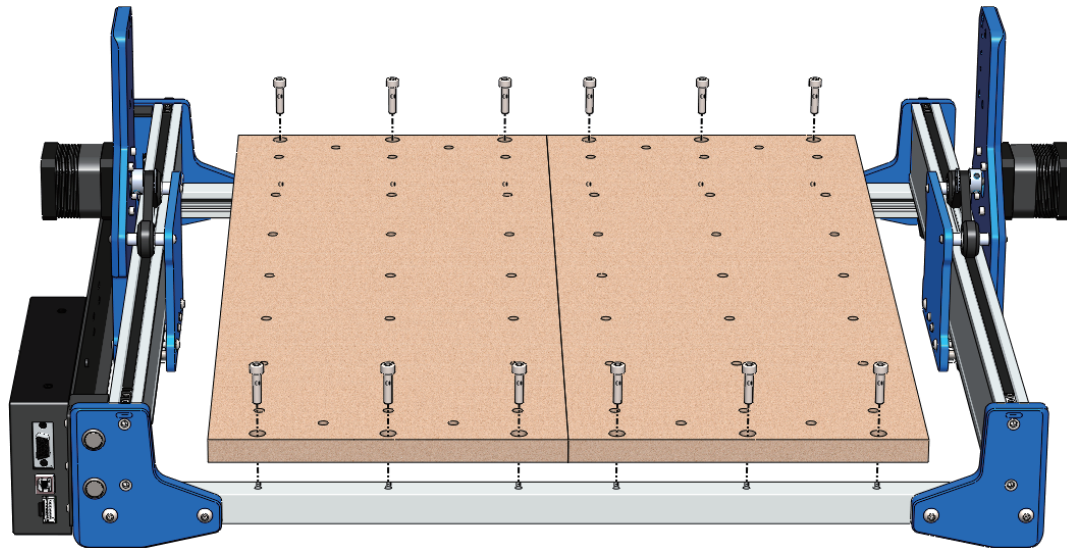

Remove the X-axis module

2. Unscrew the (4) M3 cup head socket screws and remove the (4) rubber feet.

Remember to Keep: M3 cup head socket screws and rubber feet.

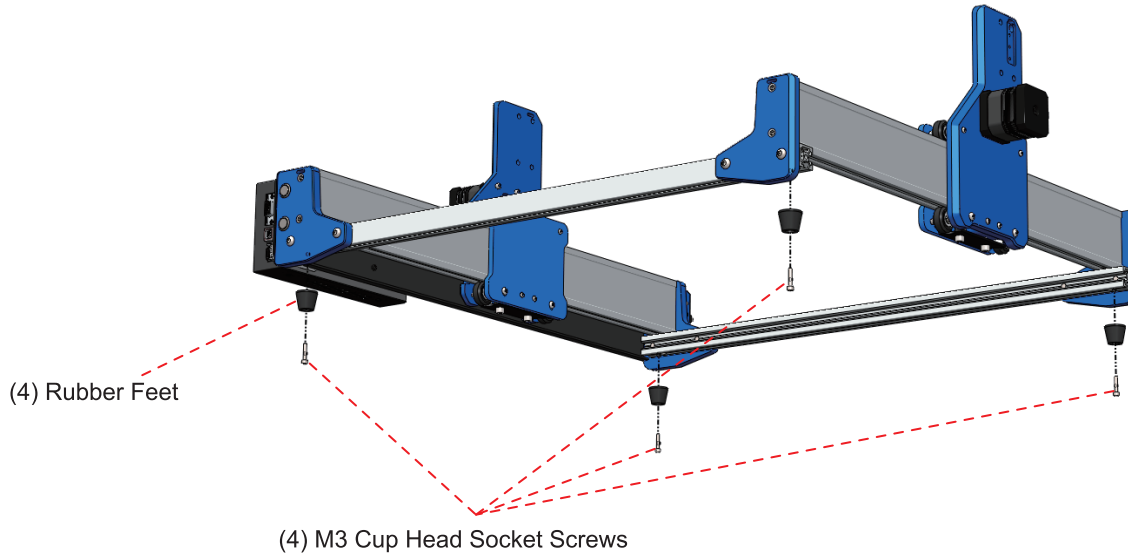

Remove the X-axis module

3. Unscrew the (8) M5 round head socket screws of the profile connecting blocks.
4. Unscrew the (4) M5 small cup head socket screws at the bottom of the profiles.

Remember to Keep: M5 round head socket screws and M5 small cup head socket screws.

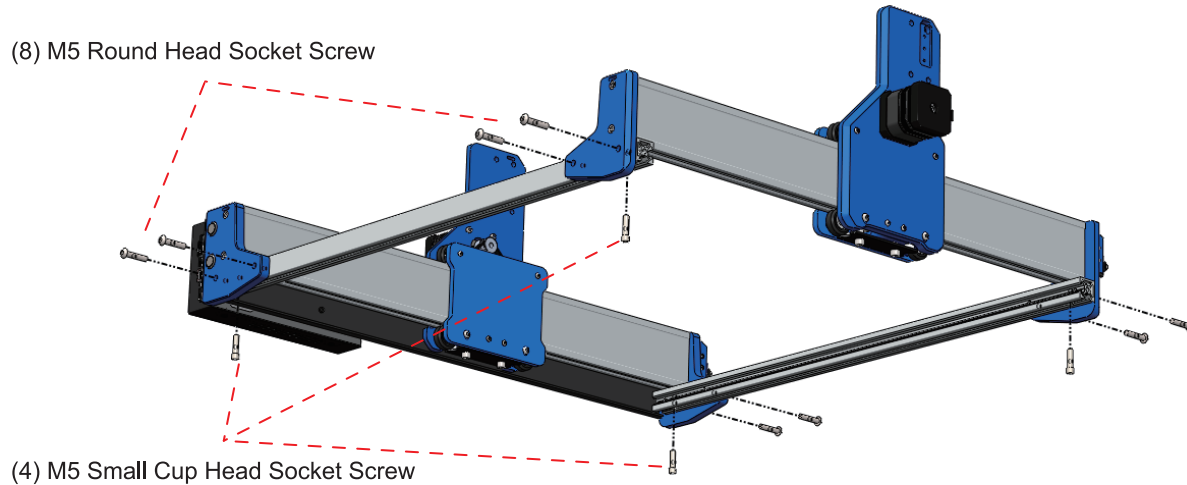



Remove the X-axis module

5. Remove the bottom profiles.

Remember to Keep: Y-axis module.

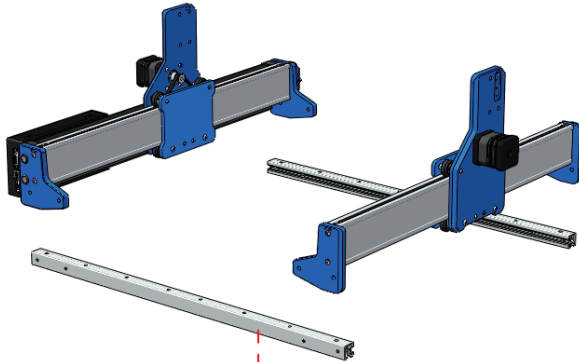

Profile

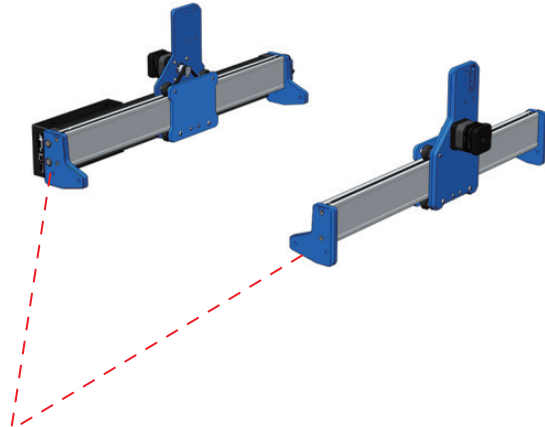

Y-axis Module

Install the X-axis Extension Module

If you need to install both X-axis and Y-axis extensions, please complete the Y-axis extension module (PART 2, turn to page XX) before installing the X-axis extension module.



Unbox (101-63-40RENO-XE60)



Customized X-axis Profile V-Slot L765mm
(Inside Penetration X-axis Limit
Cable L=840mm+250mm, Belt)



X-axis Extension Sheet Metal Backplate
(With YR Motor Cable L=820mm X-axis Motor Cable L=820mm
Z-axis Motor Cable L=860mm Z-axis Limit Cable L=960mm)



(2) Bottom Profile L783mm



Spindle Cable
L=940mm



(5) M3x4mm Cup
Head Socket Screw



(5) M3x4mm Round
Head Socket Screw



Unbox (101-63-40RENO-XE60)



(9) M3x6mm Round Head Phillips Screw



(4) M3x12mm Socket Head Cap Screw



(2) M4x3mm Flat Hexagon Socket Set Screw



(2) M5x18mm Small Cup Head Hexagon Socket Screw



(8) M5x25mm Round Head Socket Screw



D5.2-L12mm Dowel Pin

The objects marked with ★ in the items required for installation are those that have been previously removed.



Install the X-axis Extension Module

Step 1: Assemble the X-axis Module

What you need in this step of the installation:



(4) M3x6mm Round Head Phillips Screw



X-axis Extension Sheet Metal Backplate

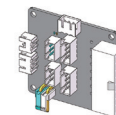

★ Circuit Board

1. Use (4) M3x6mm round head Phillips screws to mount the circuit board to the X-axis extension sheet metal backplate.
2. Connect the cables on the sheet metal backplate to the circuit board as shown.

(4) M3x6mm Round Head Phillips Screw

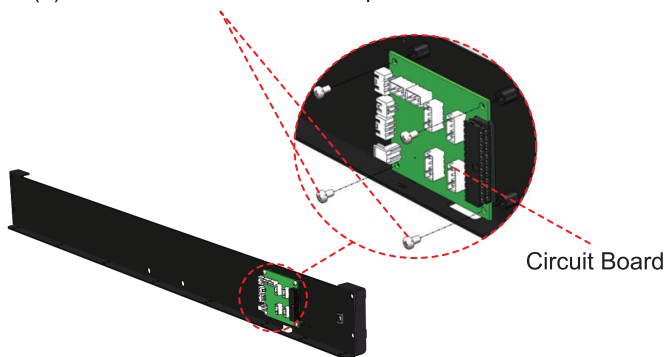

Z-Axis Limit Cable YL Motor Cable YR Motor Cable

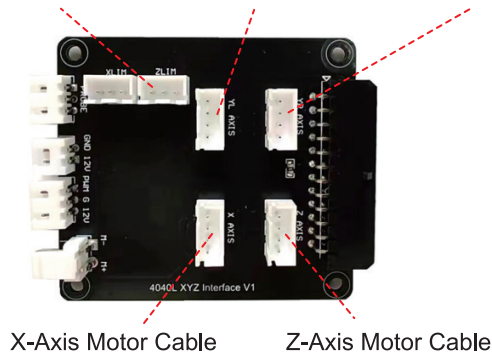

Install the X-axis Extension Module

What you need in this step of the installation:



Customized X-axis Profile V-Slot L765mm

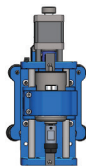

★ XZ-axis Assembly

3. Slide the XZ-axis assembly into the customized X-axis profile and pass the belt through the XZ-axis assembly as shown.

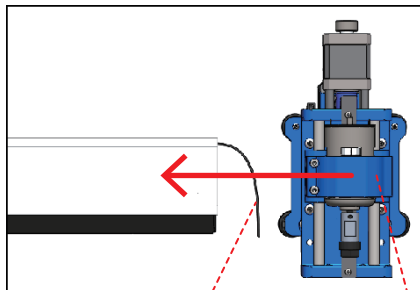

Belt

XZ-axis Assembly

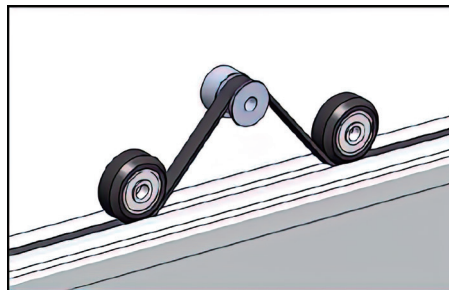

Install the X-axis Extension Module

What you need in this step of the installation:

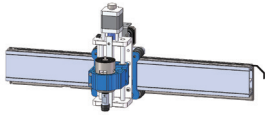

Customized X-axis Profile with
XZ-axis Assembly Installed



(4) M3x6mm Round Head Phillips Screw

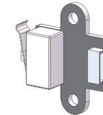

★ (2) Limit Switch

4. Use (4) M3x6mm round head Phillips screws to mount the limit switches to the customized X-axis profile.

5. Connect the X-axis limit cable terminals at each end of the X-axis profile to the limit switches.

(4) M3x6 Round Head Phillips Screw

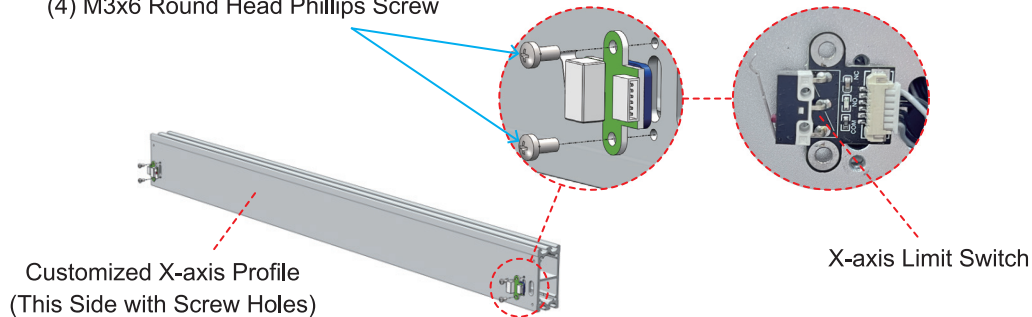

Customized X-axis Profile
(This Side with Screw Holes)

X-axis Limit Switch

Install the X-axis Extension Module

What you need in this step of the installation:



(4) M3x4mm Cup Head Socket Screw

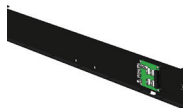

Customized X-axis Profile with Limit Switch

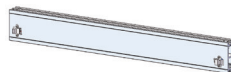

Extended Sheet Metal with Circuit Board Installed

6. Place the X-axis module upside down. Pass the X-axis limit cables through the open cable channel, and then connect to the circuit board and the limit switches on both sides.
7. Use (4) M3x4 cup head socket screws to mount the sheet metal backplate to the X-axis profile.
8. Secure the X-axis limit cable to the bottom of the sheet metal backplate using cable ties.

(4) M3x4mm Cup Head Socket Screw

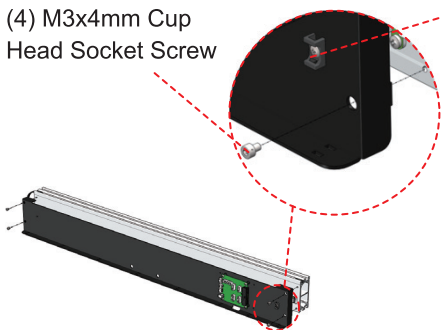

Tie Set(Cable Holder)

Open Cable Channel

Tie Set(Cable Holder)

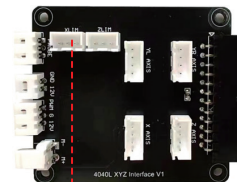
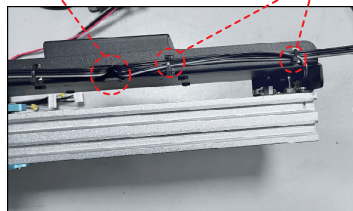

X-axis Limit Cable

Install the X-axis Extension Module

What you need in this step of the installation:



(4) M3x4mm Round
Head Socket Screw

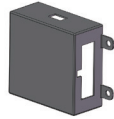

★ Sheet Metal Housing

9. Use (4) M3x4mm round head socket screws to mount the sheet metal housing, to the sheet metal backplate, tighten the screws.

Take care to gather the cables into the open cable channel. Do not crush the cables.

(4) M3x4 Round Head Socket Screw

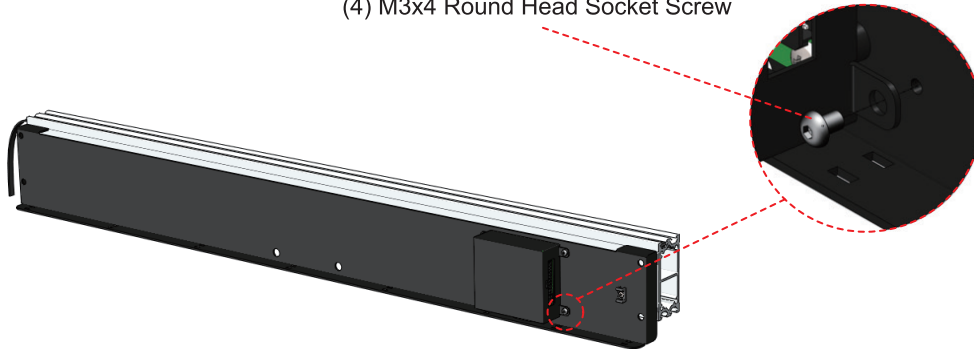



Install the X-axis Extension Module

What you need in this step of the installation:



★ Belt Lever

10. Fit the belt lever into the X-axis profile.

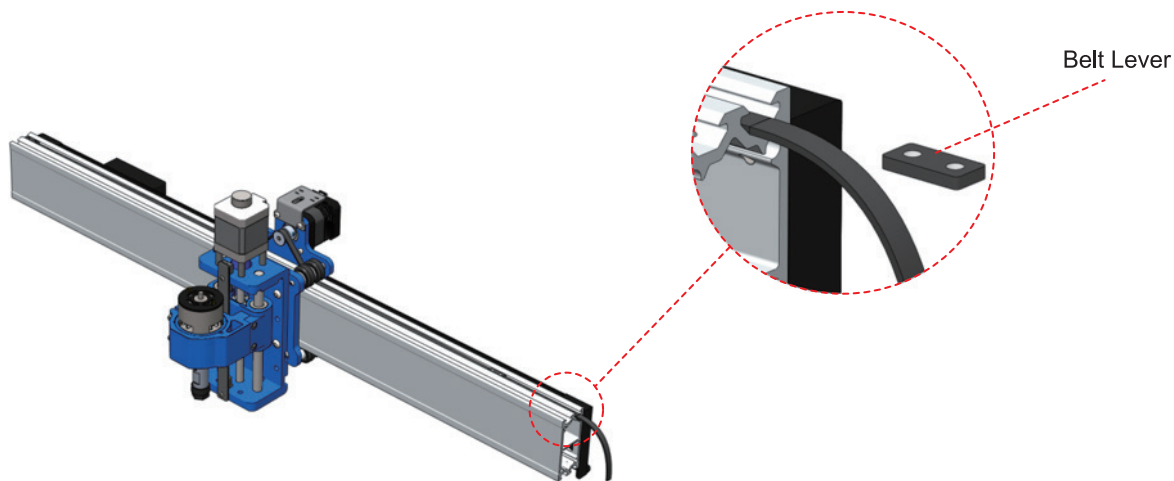

Install the X-axis Extension Module

Step 2: Assemble the Y-axis Module

What you need in this step of the installation:



★ (4) M5 Small Cup
Head Socket Screws



★ (8) M5 Round
Head Socket Screws



(2) Bottom
Profile L783mm

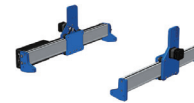

★ Y-axis Module

1. Use (4) M5 small cup head socket screws, through the holes in the bottom profile and install them into the slider nuts on the bottom of the YL&YR profile.

TIP: Do not tighten the screws.

2. Use (8) M5 round head socket screws to install bottom profile into the YL&YR front and rear guards. Tighten them after all screws have been screwed into the screw holes.
3. Finally, tighten the M5 small cup head socket screws.

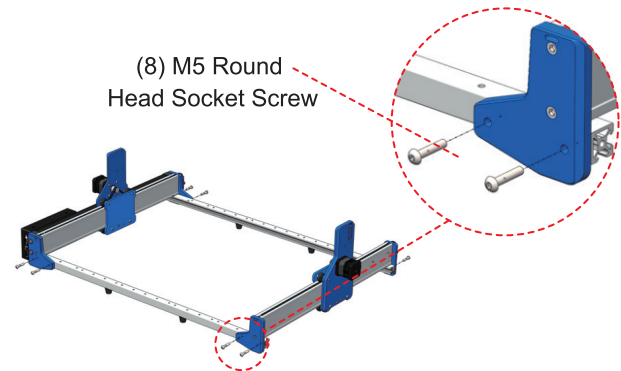
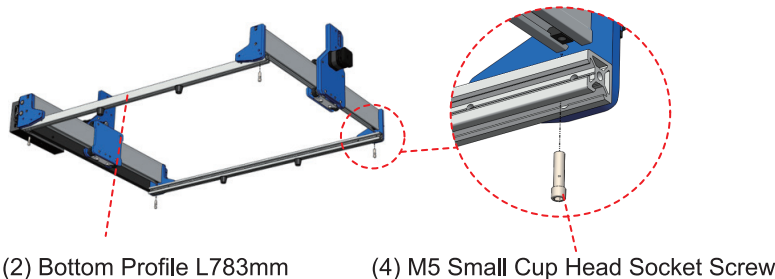



Install the X-axis Extension Module

What you need in this step of the installation:



★ Rubber Feet



★ (4) M3 Cup Head Socket Screws

4. Use (4) M3 cup head socket screws to mount the rubber feet to the bottom profiles.

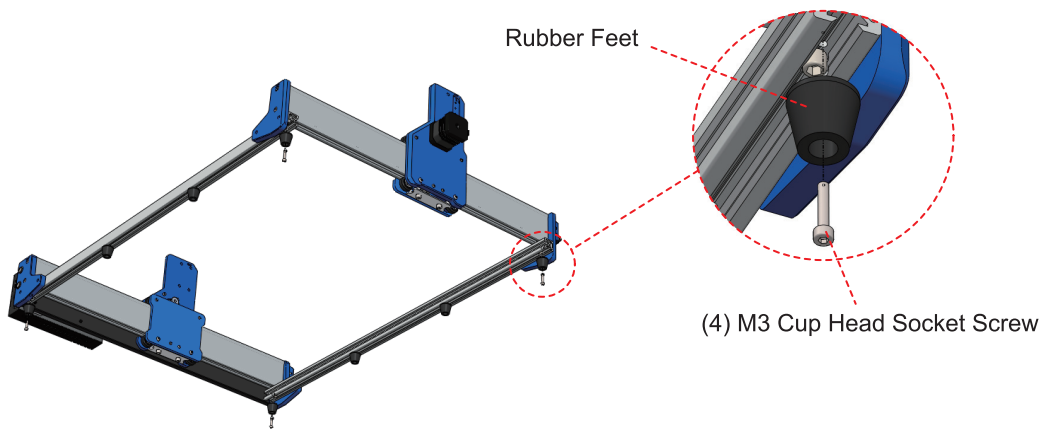

Install the X-axis Extension Module

Step 3: Assemble the X-axis Module to the Y-axis Module

What you need in this step of the installation:



(1) M5x18mm Small Cup Head Hexagon Socket Screw

(7) M5x25mm Round Head Socket Screw

1. Before installing, the belt needs to be retracted into the X-axis profile.
2. Embed the XZ module between the YL & YR vertical plates.
3. Pass the belt through the YR vertical plate slot.
4. Use (7) M5x25mm round head socket screws and (1) M5x18mm small cup head hexagon socket screw, through the YL & YR vertical plates to connect the X-axis module.

Install the X-axis Extension Module

5. After screwing all the screws into the screw holes, tighten the screws in a cross pattern.

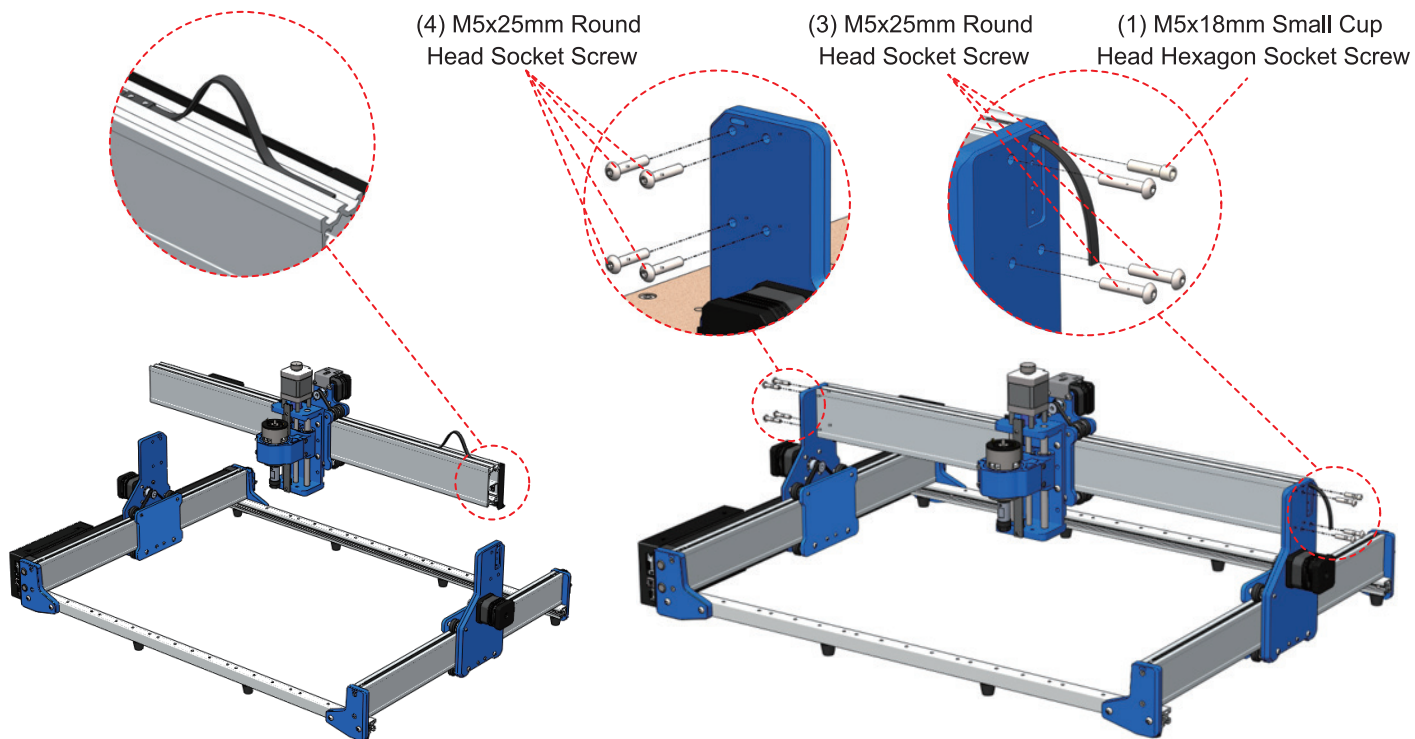

Install the X-axis Extension Module

Step 4: Assemble the Belt Tensioner

What you need in this step of the installation:



★ Belt Tensioner Slider Block



★ M3x12mm Socket Head Cap Screw

1. Use (3) M3x12mm hex socket flat head cap screws, through the belt tension holder and install it on the YR module vertical plate.

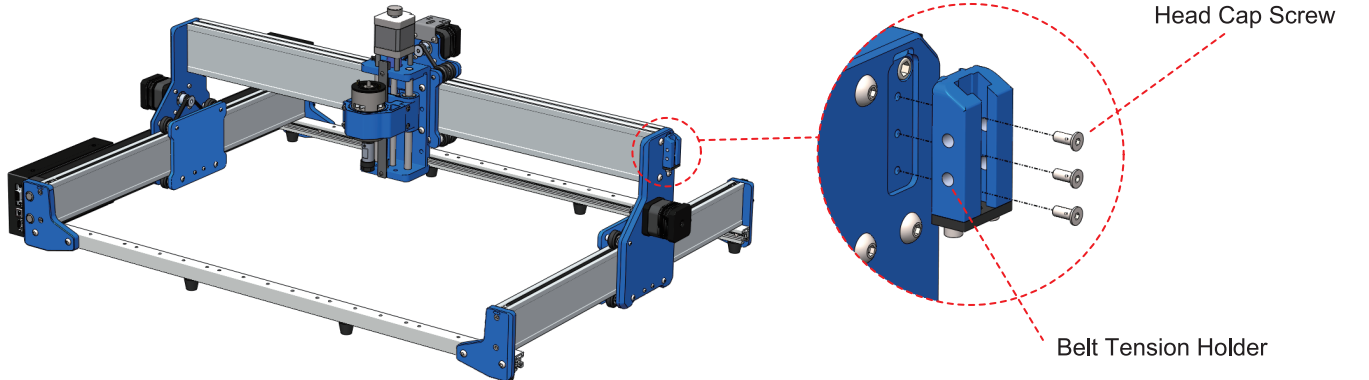

Install the X-axis Extension Module

What you need in this step of the installation:



★ Belt Tension Holder



★ (3) Hex Socket Flat Head Cap Screw

2. Remove compression sheet metal and screws from belt tensioner slider block.

3. Install the belt tensioner slider block into the belt tension holder and make the top of the slider flush with the end of the slider locating screw.

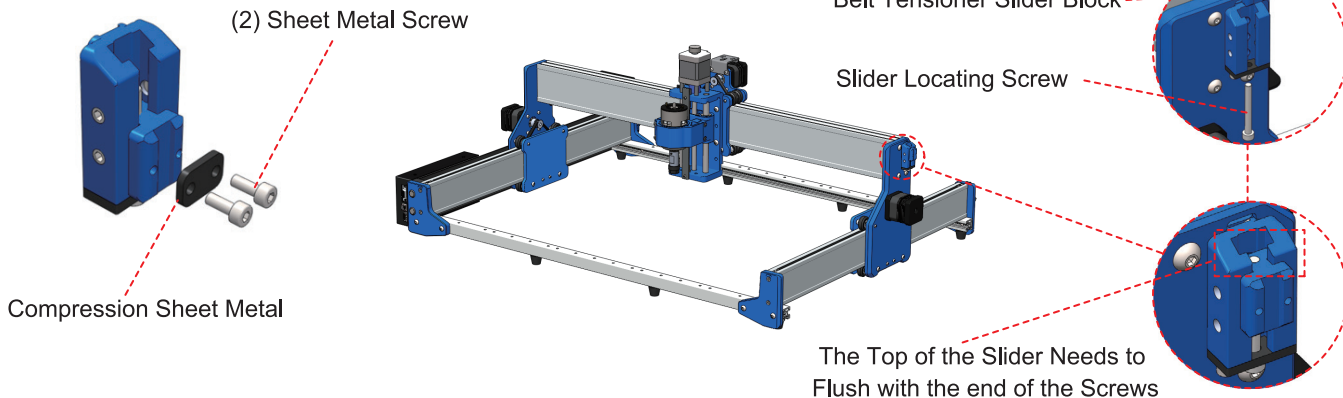



Install the X-axis Extension Module

What you need in this step of the installation:



★ Compression Sheet Metal



★ (2) Sheet Metal Screw



D5.2-L12mm Dowel Pin

4. Install the removed compression sheet metal onto the slider block, not lockable, leaving enough gap.

5. Fold the belt inward and press the smooth side of the belt against the dowel pin.

Compression Sheet Metal

Leave a Gap

Press the Smooth Side of
the Belt against the Dowel Pin

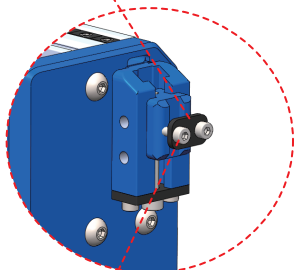

(2) Sheet Metal Screw

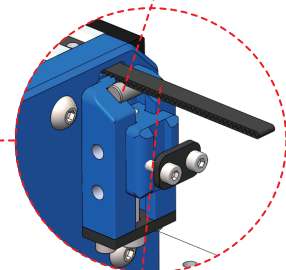
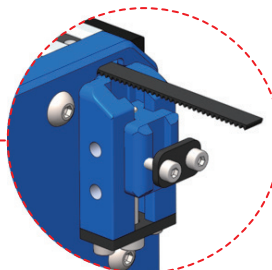
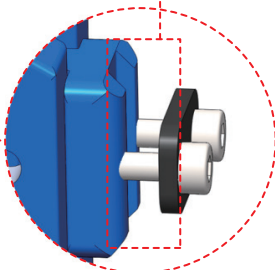

Fold the Belt Inward

Install the X-axis Extension Module

6. Thread the end of the belt into the compression sheet metal and slider gap and lock the belt tensioner sheet metal screws.

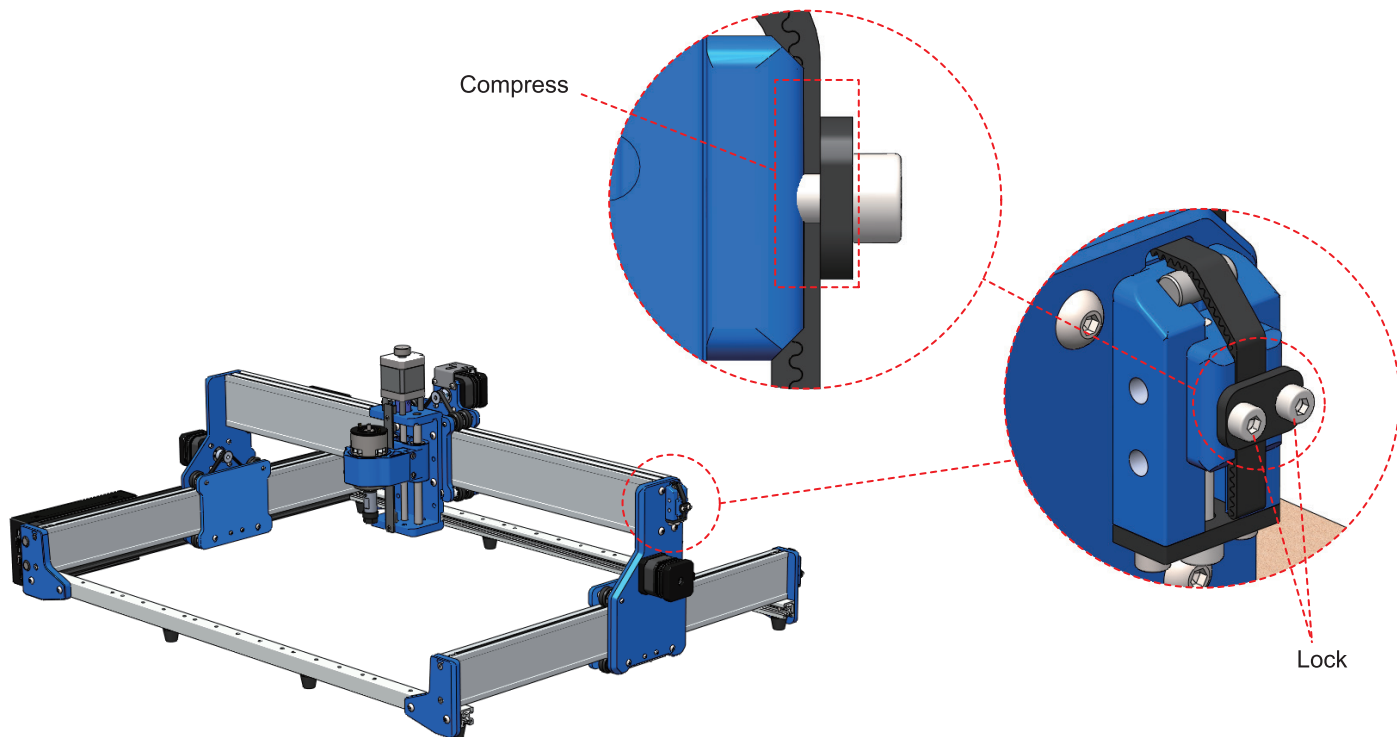



Install the X-axis Extension Module

What you need in this step of the installation:



★ (4) Tightening Screws

7. Adjust the belt to the proper tension by screwing the slider locating screw.

8. Lock the (4) tightening screws on both sides of the belt tensioner.

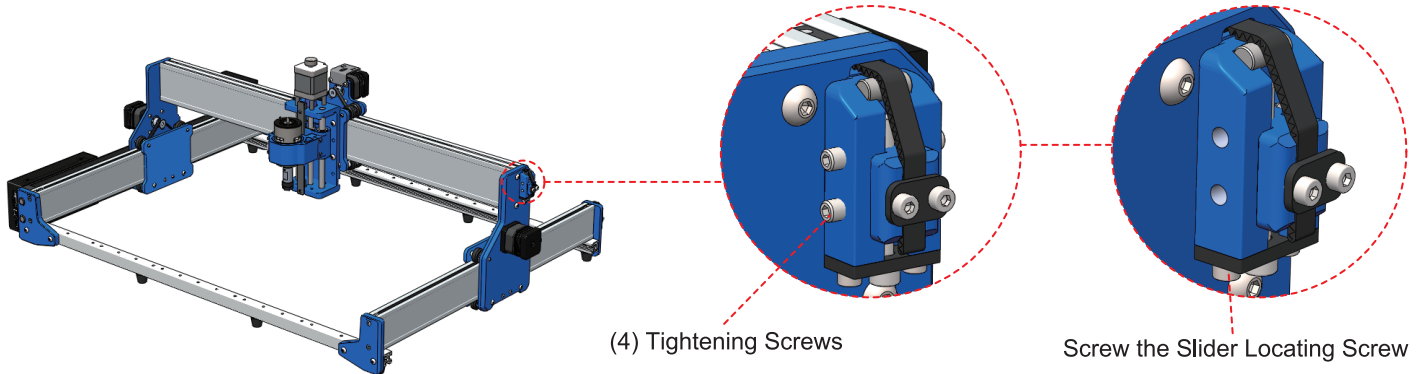

Install the X-axis Extension Module

What you need in this step of the installation:



(2) M4x3mm Flat Hexagon Socket Set Screw

9. Use (2) M4x3mm flat hexagon socket set screws to screw into the belt lever to hold the belt in place. Slide the Z-axis module and feel the smooth movement of the module.

Note: Do not tighten the setscrews too much, there is a probability that the belt will be pressed off, and the belt tightness will be affected.

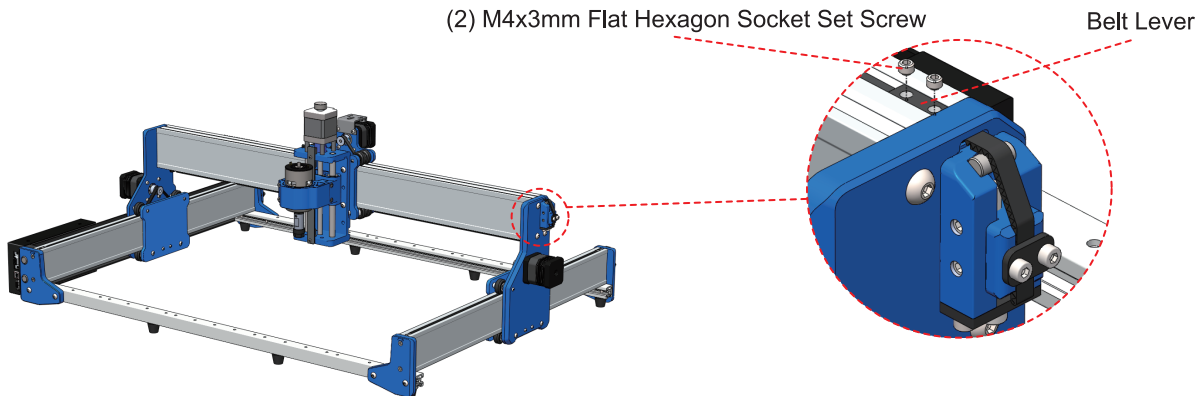



Finished

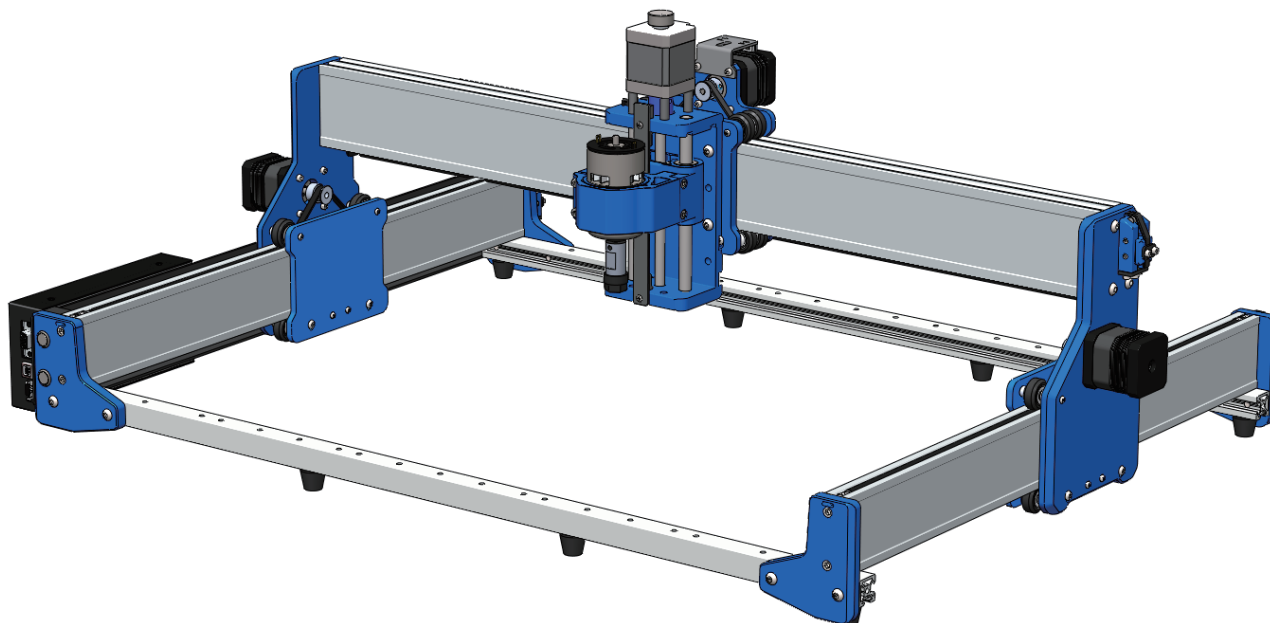

PART 2: Y-axis Extension Module

Remove the Y-axis module

Step 1: Disconnect Cables

Gently disconnect and remove all the cables connected.

Tip: Note how and where each cable is connected for easy reconnection later.

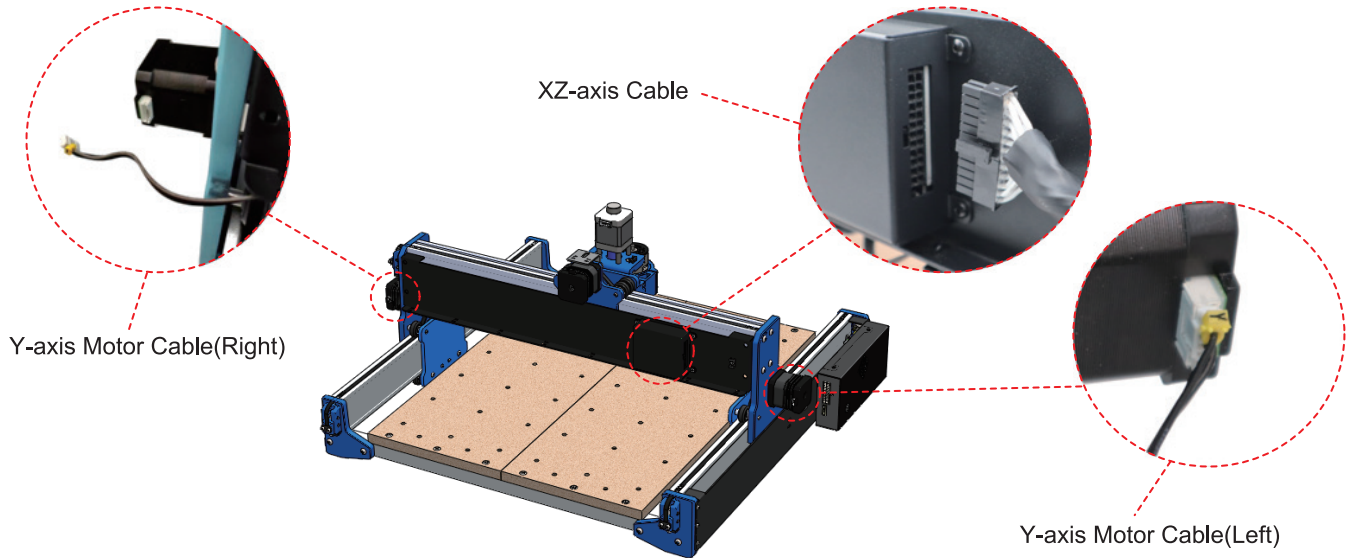



Remove the Y-axis module

Step 2: Remove the X-axis Module

1. Loosen the belt tensioners screw and pull out the end of the belt.

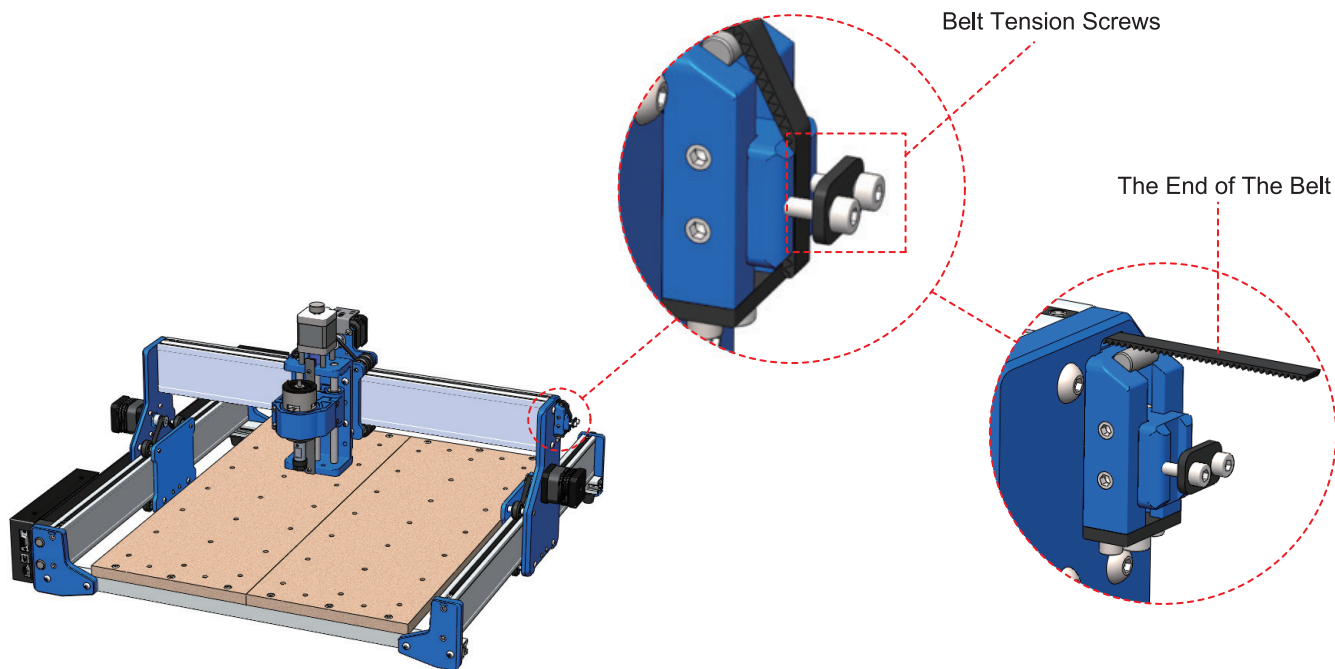

Remove the Y-axis module

2. Loosen the (4) tightening screws, then remove the isolation column (dowel pin) and belt tensioner slider block.
3. Unscrew and remove the slider locating screws.

Remember to Keep: belt tensioner slider block, tightening screws and slider locating screw.

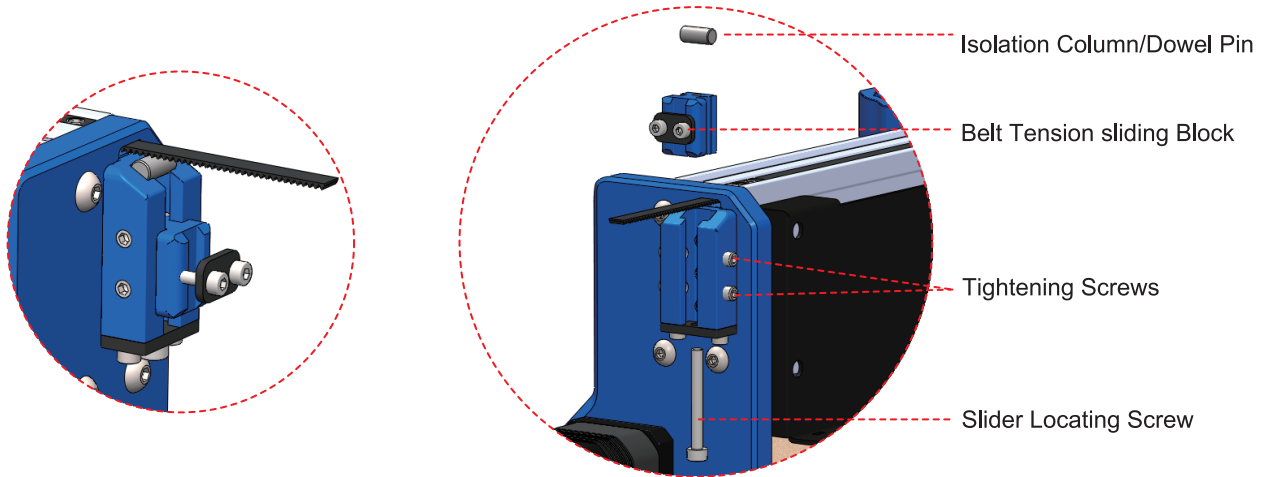



Remove the Y-axis module

4. Unscrew the (3) hex socket flat head cap screws on the belt tensioner holder, and removed the belt tension holder.

Remember to Keep: Hex Socket Flat Head Cap Screws and belt tensioner holder.

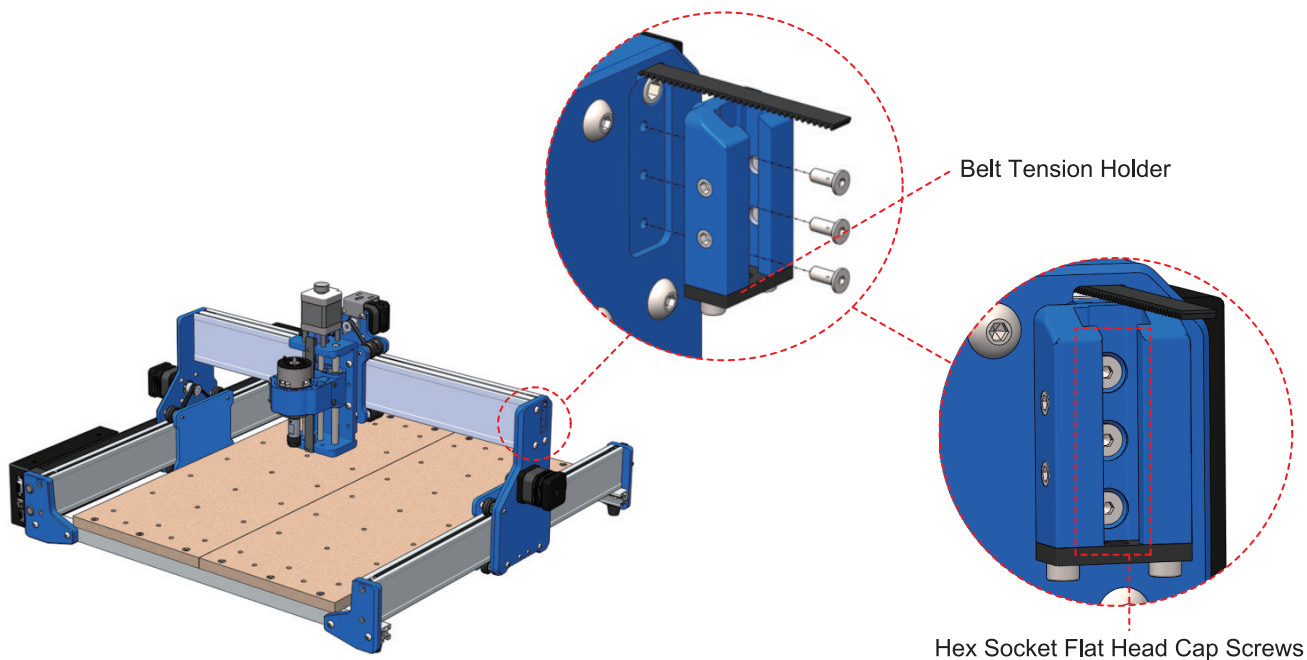

Remove the Y-axis module

5. Unscrew the (4) X-axis compression belt screws at the XY-axis vertical plate on the side of the belt tensioner as shown, and pull the belt out of the riser here. (Not pulling out the belt will make subsequent removal of the XZ module more laborious.)

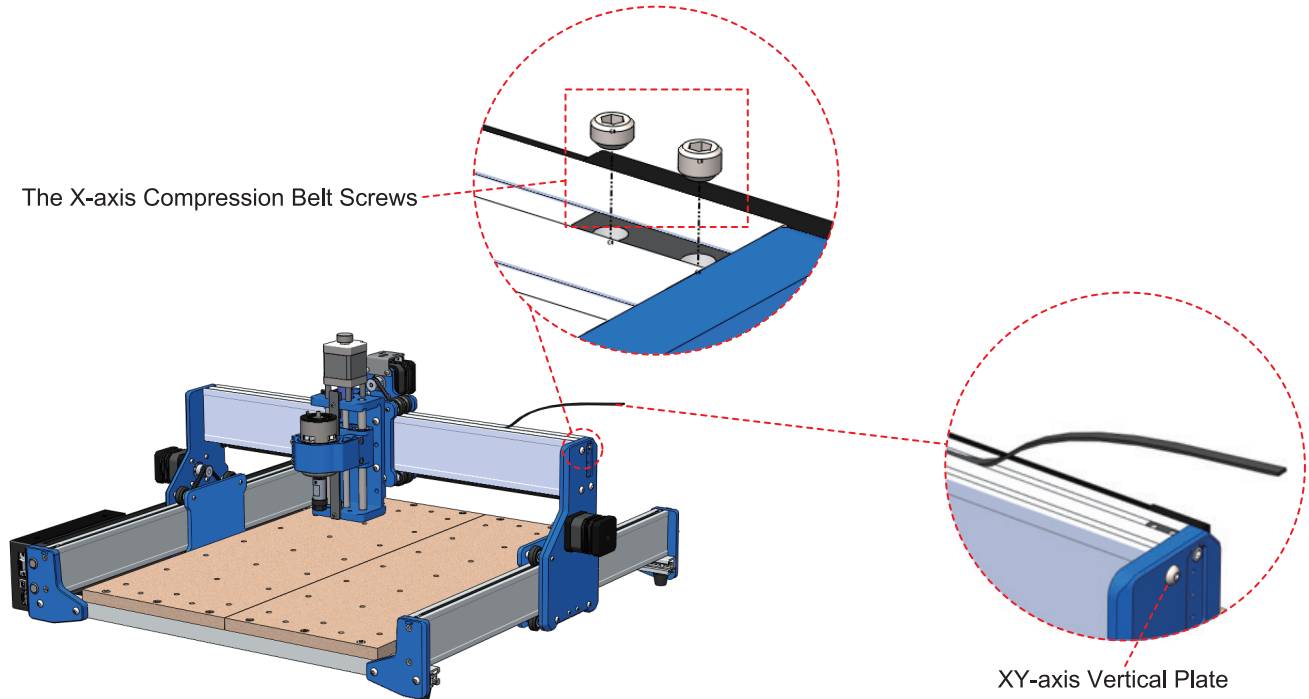



Remove the Y-axis module

6. Unscrew the (8) screws (7xM5 round head socket head screws + 1xM5 small cup head socket head screw) at the two XY-axis vertical plates, followed by carefully removing the X-Z module.

Remember to Keep: M5 round head socket head screws and M5 small cup head socket head screw.

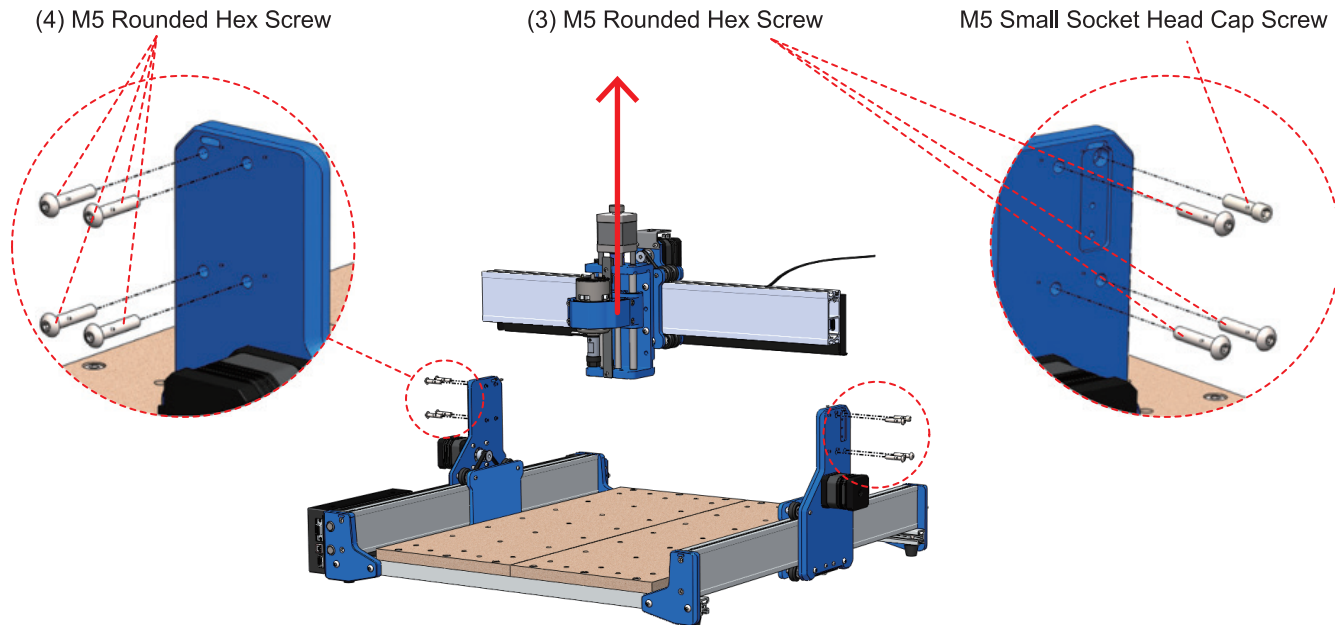



Remove the Y-axis module

Step 3: Remove the Y-axis Module Platform and MDF Board

1. Unscrew the (12) M5 cup head socket screws and remove the (2) MDF boards.

Remember to Keep: M5 cup head socket screws and MDF boards.

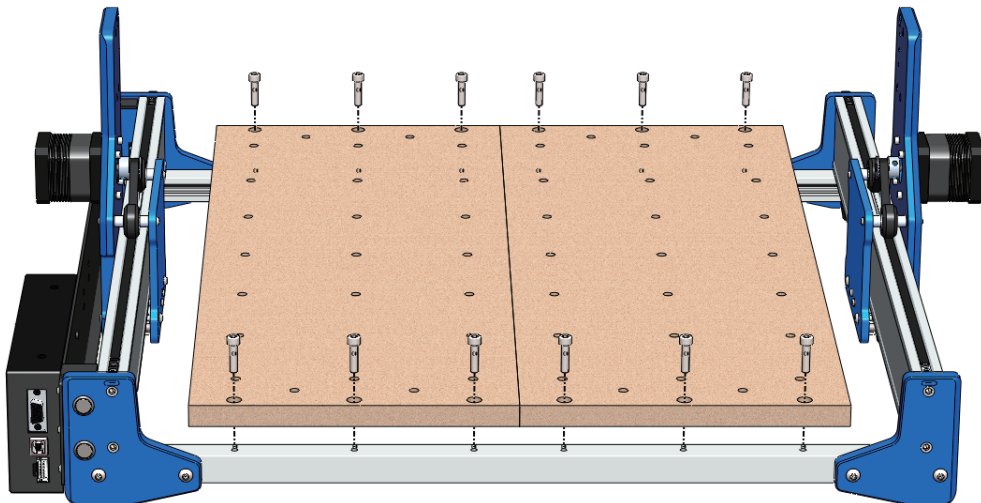

Remove the Y-axis module

2. Unscrew the (4) M3 cup head socket screws and remove the (4) rubber feet.

Remember to Keep: M3 cup head socket screws and rubber feet.

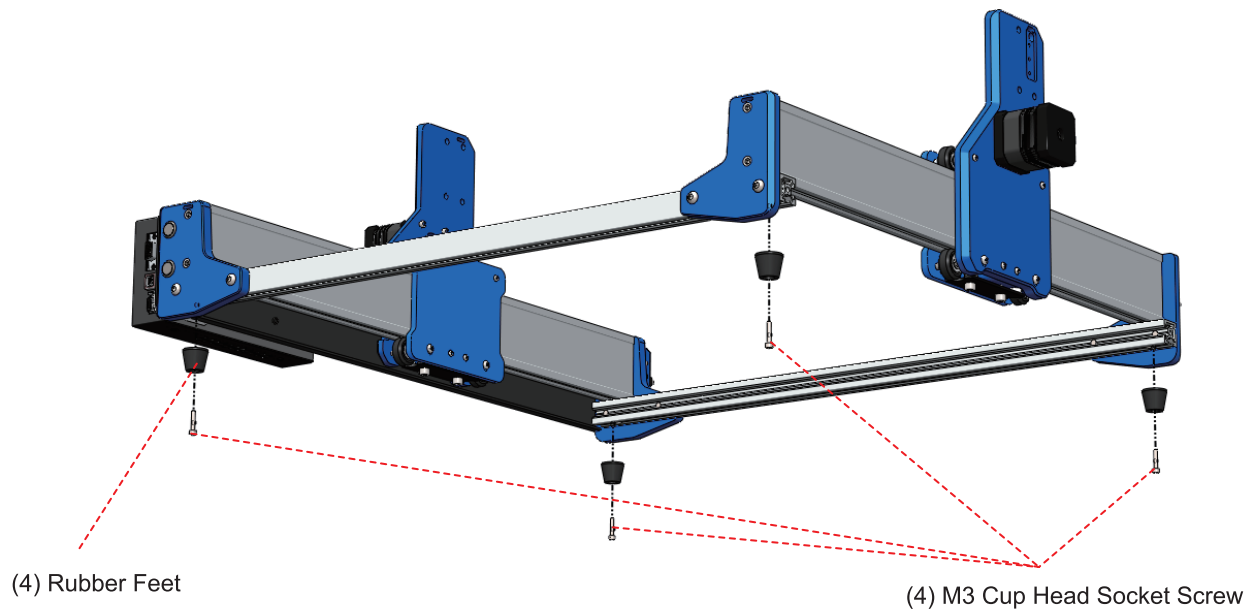

Remove the Y-axis module

3. Unscrew the (8) M5 round head socket screws of the profile connecting blocks.
4. Unscrew the (4) M5 small cup head socket screws at the bottom of the profiles.

Remember to Keep: M5 round head socket screws and M5 small cup head socket screws.

(8) M5 Round Head Socket Screw

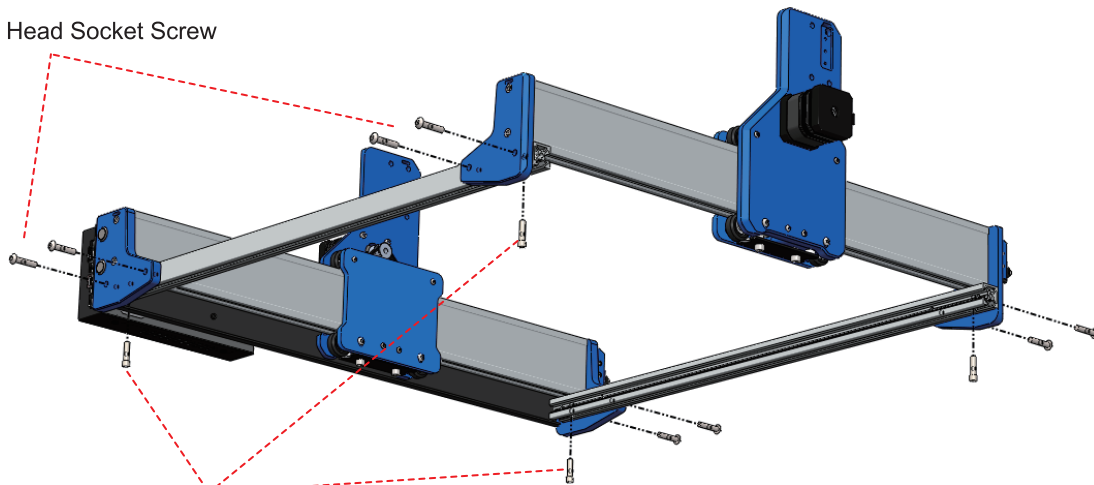

(4) M5 Small Cup Head Socket Screw



Remove the Y-axis module

5. Remove the bottom profiles.

Remember to Keep: bottom profiles.

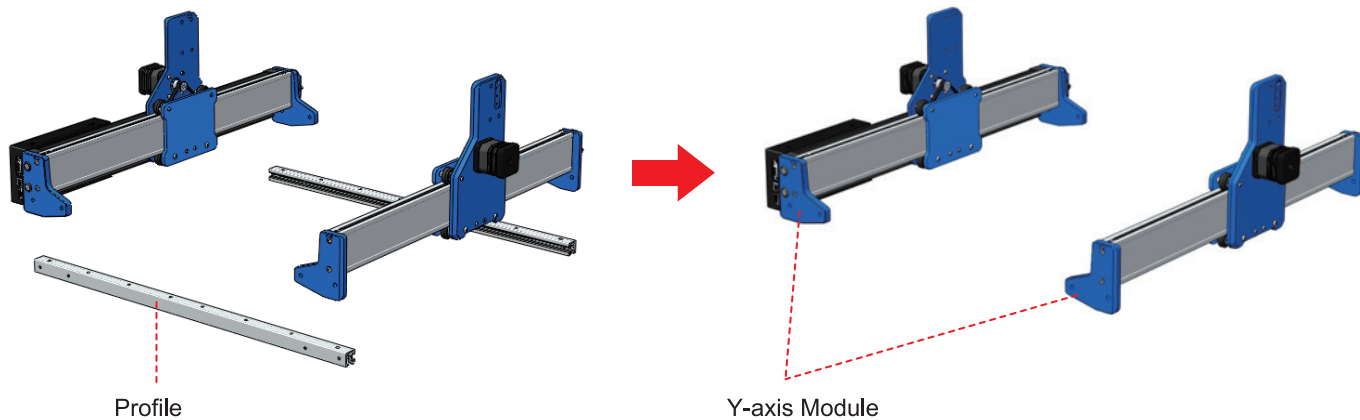

Remove the Y-axis module

Step 4: Remove the YL&YR Module

1. Disassembling the electronic control box.

1.1 Disconnect all cables to the YL electronic control box as shown.

1.2 Unscrew the (4) M3 round head socket screws from the electronic control box with the 2mm Allen wrench. Then carefully remove the electric control box.

Remember to Keep: M3 gasket.

At this time, the fan connector terminals and DC power connector terminals are connected to the control board, be careful not to tear the cable when removing the electronic control box.

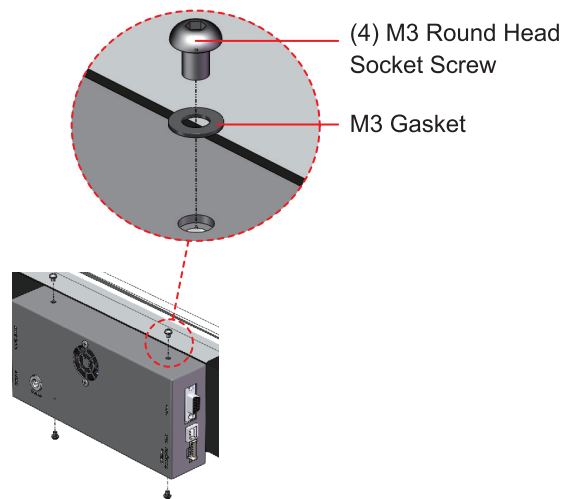
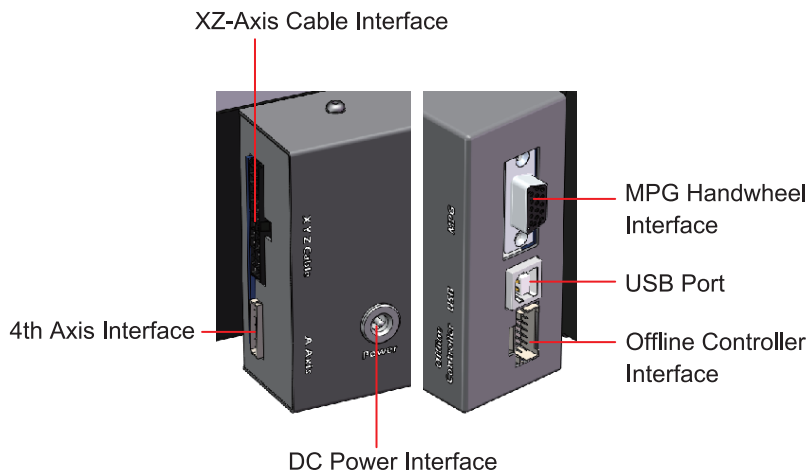

Remove the Y-axis module

1.3 Unplug some of the terminals on the control board as shown.

Remember to Keep: sheet metal housing of the control box.

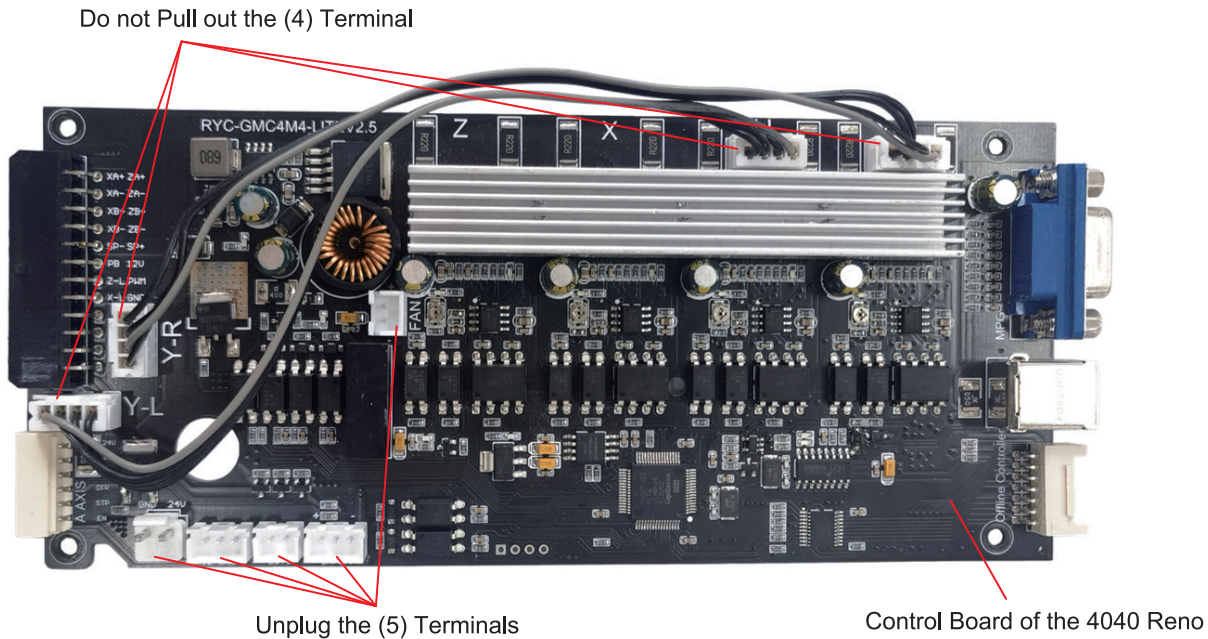

Remove the Y-axis module

1.4 Unscrew the (4) round head Phillips screws securing the control board and remove the control board.

Remember to Keep: control board.

1.5 Unscrew the (4) M3 round head screws securing the control box baseplate and remove the control box baseplate.

Remember to Keep: control box baseplate.

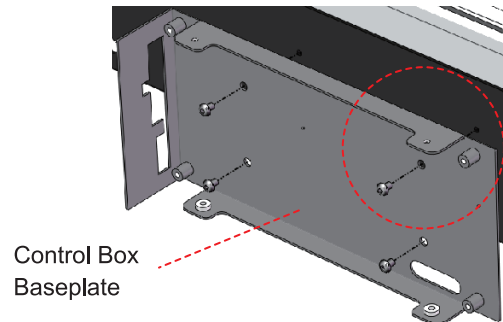
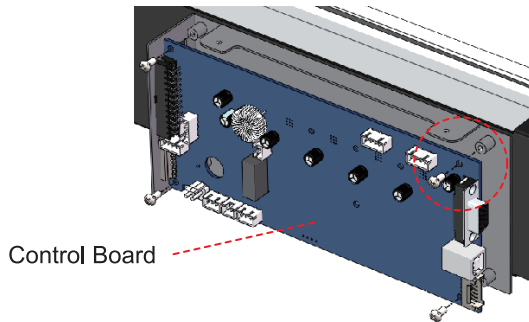
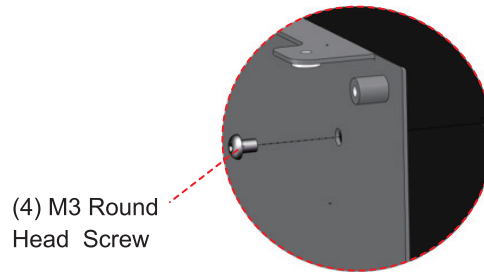
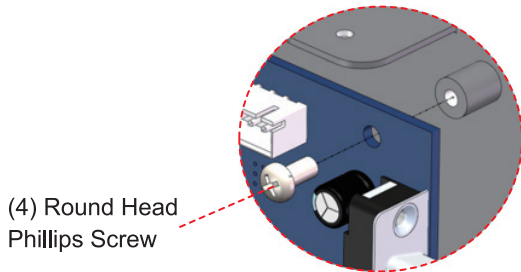



Remove the Y-axis module

2. Unscrew the (6) M3 round head screws securing the sheet metal baseplate and remove the sheet metal baseplate.

TIP: If you find the screws difficult to unscrew during disassembly, you can use a hot air gun to heat the screws and then unscrew them, this initiative will reduce the difficulty of disassembly.

3. Unscrew the (4) set screws securing the limit switch and remove the limit switch.

Remember to Keep: limit switches.

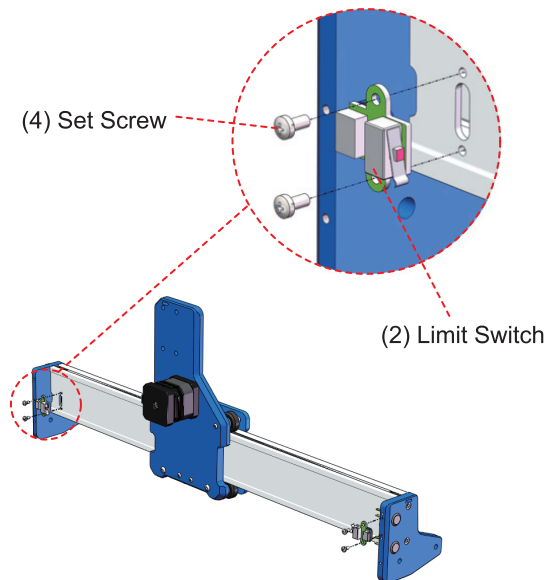
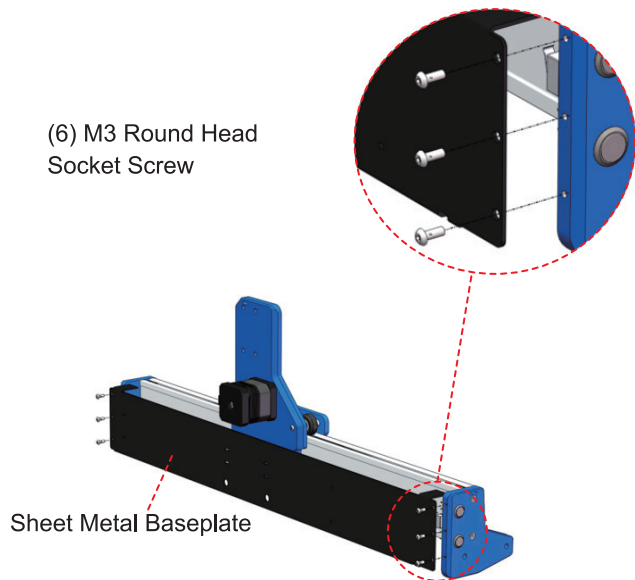

Remove the Y-axis module

Step 5: Assemble the Belt Tensioner (YL & YR operate identically and can be synchronized.)

1. Loosen the belt tensioner screw and pull out the end of the belt, then remove the isolation column (dowel pin).
2. Loosen the (4) tightening screws, and remove the belt tensioner slider block.
3. Unscrew and remove the slider locating screws.

Remember to Keep: belt tensioner slider block, tightening screws and slider locating screw.

4. Unscrew the (3) hex socket flat head cap screws on the belt tensioner mount, after which the belt tensioner holder can be removed.

Remember to Keep: dowel pin, belt tensioner slider block, slider locating screw, tightening screws, hex socket flat head cap screws and belt tensioner holder.

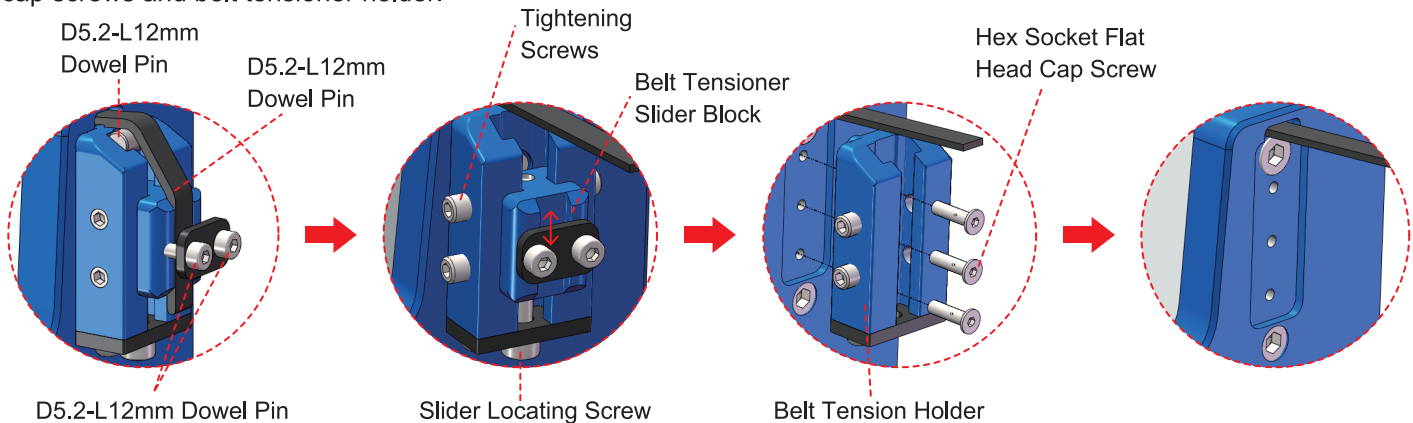

Remove the Y-axis module

Step 6: Disassembling the YL&YR Module

(YL & YR operate identically and can be synchronized.)

1. Unscrew the (4) M5 round head screws holding the front and rear guards of the Y-module and remove the front and rear guards.

Remember to Keep: front and rear guards.

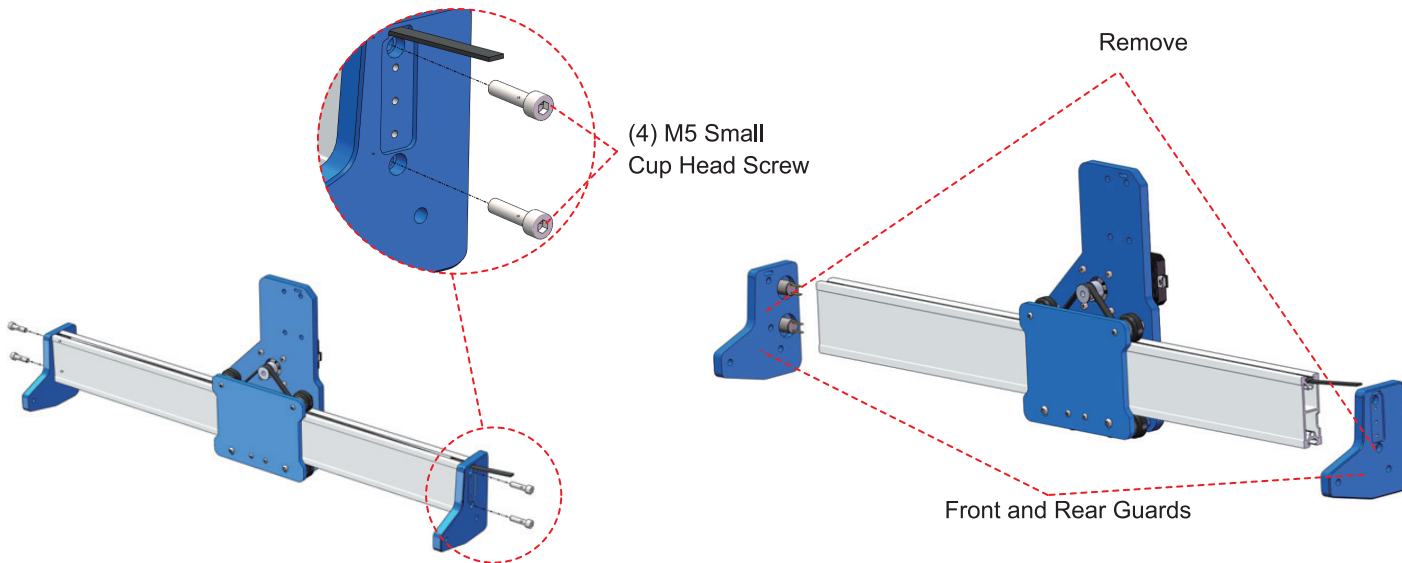

Remove the Y-axis module

2. Unscrew the (2) M4 Y-axis compression belt screws that hold the belt lever and remove the belt lever from the profile.
3. Slide the Y-axis assembly out of the Y-axis custom profile.

Remember to Keep: belt lever, M5 small cup head screws and Y-axis assemblies.

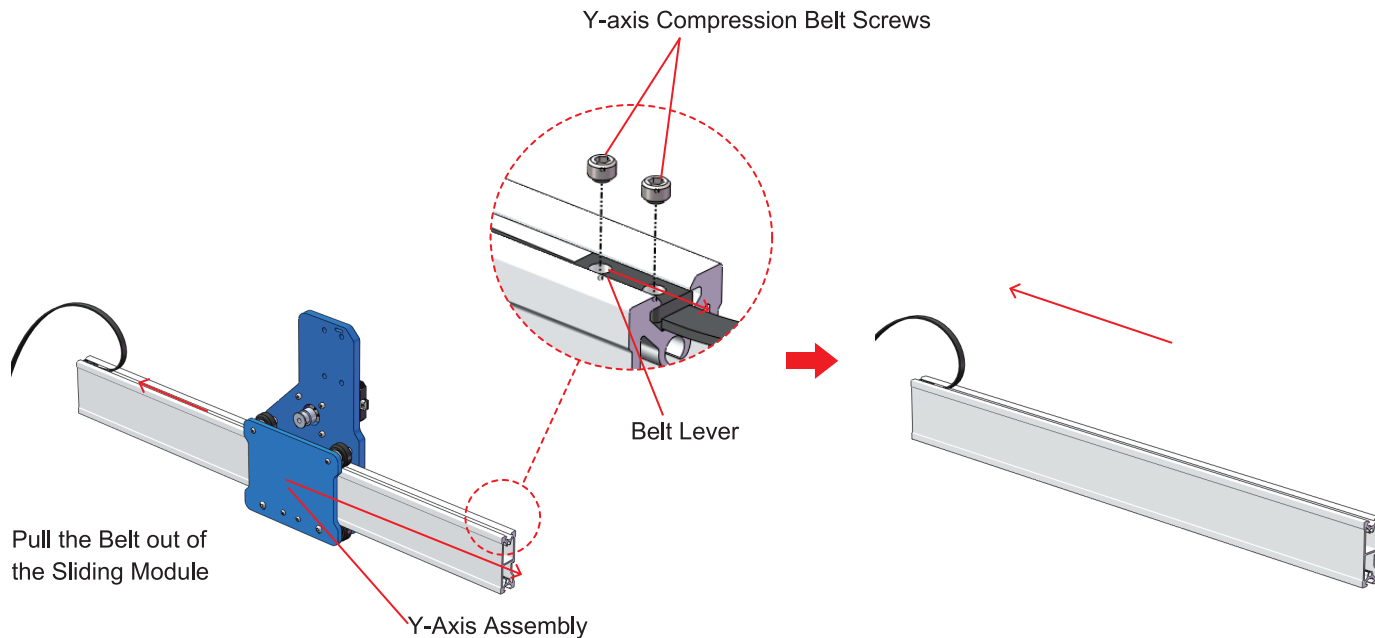

Install the Y-axis Extension Module

If you need to install both X-axis and Y-axis extensions, this is the part you need to complete first, come along and experience the installation journey!



Unbox (101-63-40RENO-YE80)



Customized Y-axis Left Profile L975mm
(Inside Belt L1133mm, Y-L Limit Cable
1050+300mm.) Short for YL profile



Customized Y-axis Right Profile
L975mm (Inside Belt L1133mm.)
Short for YR profile



Y-axis Left Extension
Sheet Metal Backplate



2020 Long Profile
L934mm



2020 Short Profile
L399mm



(12) Internal Angle Connector
Joint Bracket (with M5 Set Screws)



(7) M3x12mm Socket
Head Cap Screw



Unbox (101-63-40RENO-YE80)



(7) M3x8mm Round Head Socket Screw



(9) M3x4mm Round Head Socket Screw



(9) M3x6mm Round Head Phillips Screw



2mm、 2.5mm



Dowel Pin



X-Z Module Cable
L780mm



(4) M4x3mm Flat Hexagon Socket Set Screw



User Manual

The objects marked with ★ in the items required for installation are those that have been previously removed.



Install the Y-axis Extension Module

Step 1: Assemble the Y-axis Left Module

What you need in this step of the installation:



Customized Y-axis Right Profile L975mm
(Inside Belt L1133mm.) Short for YR profile

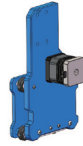

★ Y-axis Left Assembly

Belt already secured at one end in the profile

1. Slide the YL left assembly into the YL profile. Motor terminals toward the unsecured end of the belt, as shown.

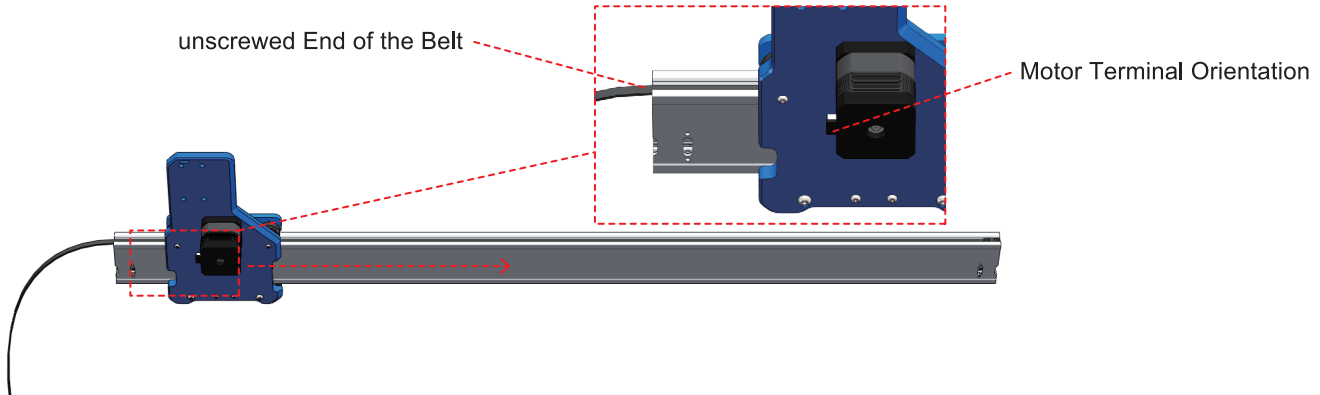



Install the Y-axis Extension Module

2. Pass the belt through the Y-axis left assembly as shown.

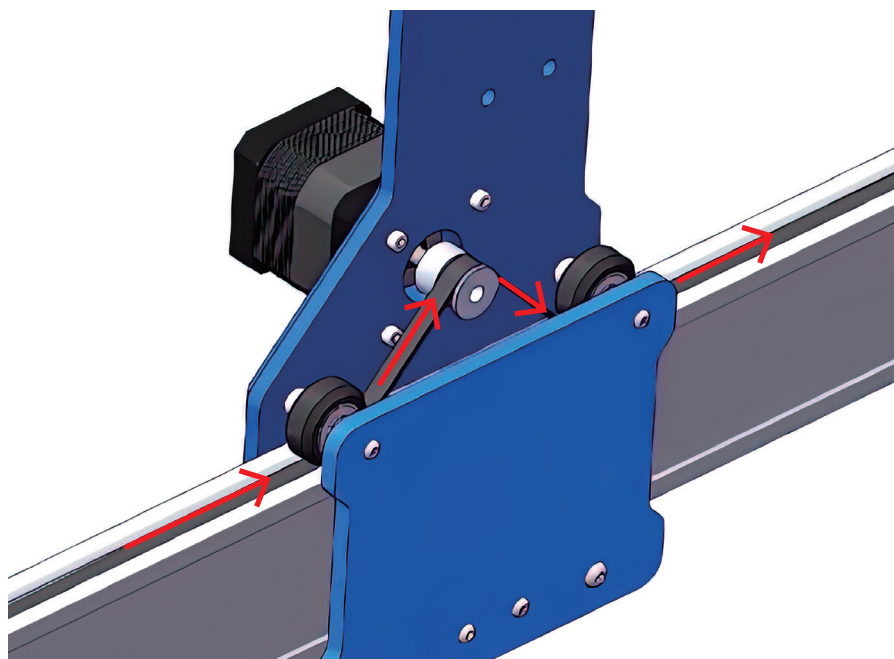

Install the Y-axis Extension Module

What you need in this step of the installation:

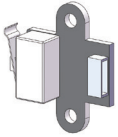

★ (2) limit switch (4) M3x6mm Round Head Phillips Screw

3. Connect the Y-axis limit cable terminals threaded inside the extended YL profile to the (2) limit switches.

4. Use (4) M3x6mm round head Phillips screws through the limit switch to mount the limit switches to the extended YL profile

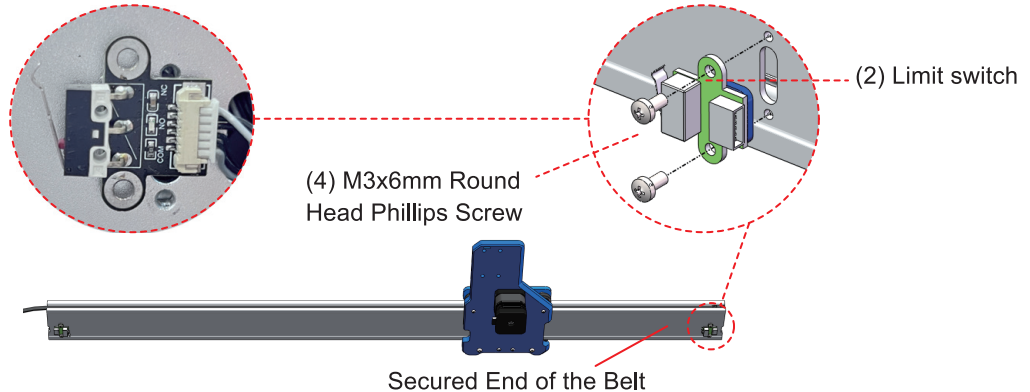



Install the Y-axis Extension Module

What you need in this step of the installation:



★ (2) limit switch



★ Front Guard with the Power Button



★ Rear Guard (Left)



★ (4) M5 small cup head screws

5. Fit the belt lever into the profile from the unsecured end of the belt. Take care when fitting that the belt lever presses against the belt at the top of the belt.

6. Use (4) M5 small cup head screws to mount the YL module front and rear guards to the profile, as shown.

TIPS: 1. Pay attention to the front and rear guards mounting direction.

2. Note that the belt need to be threaded into the rear guard slot.

Unsecured the end of the Belt

(4) M5 Small Cup Head Screw

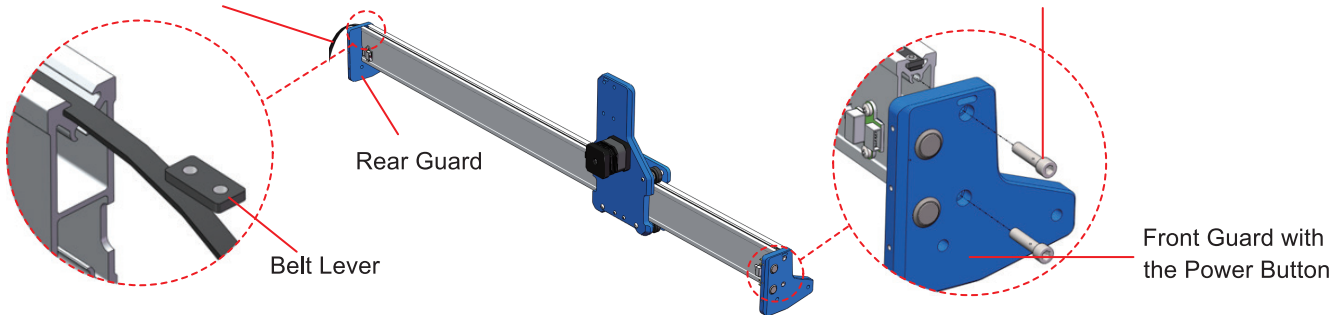

Install the Y-axis Extension Module

What you need in this step of the installation:



Y-axis Left Extension
Sheet Metal Backplate

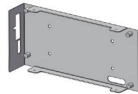

★ Control Box Baseplate



(6) M3x8mm Round
Head Socket Screw



(4) M3x4mm Round
Head Socket Screw

7. Use (6) M3x8mm round head socket screws to attach the sheet metal backplate to the front and rear guards of the YL module, as shown.

8. Use (4) M3x4mm round head socket screws to mount the control box baseplate to the sheet metal backplate.

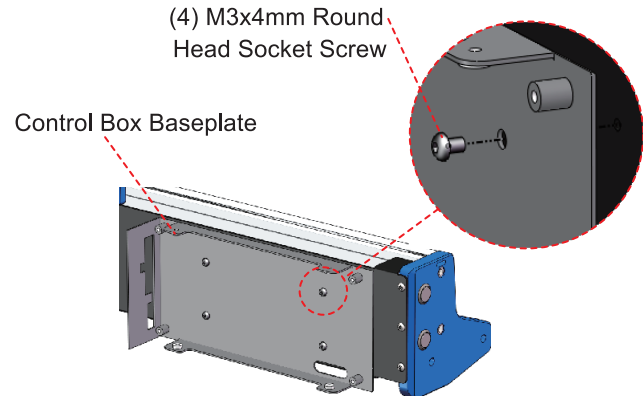
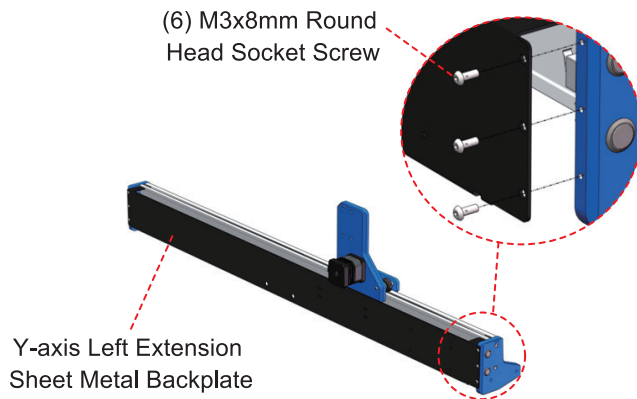



Install the Y-axis Extension Module

What you need in this step of the installation:

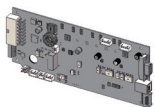

★ Control Board of the 4040 Reno

Control Board of the 4040 Reno

9. Extend the cables through the open cable channel in the control board.

10. Use (4) M3x6mm round head Phillips screws to mount the control board to the control box baseplate.

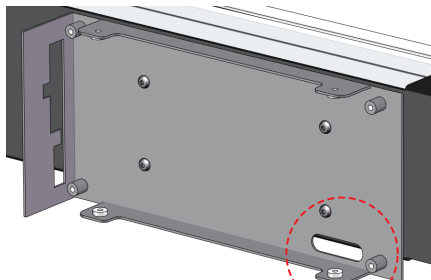

Open Cable Channel

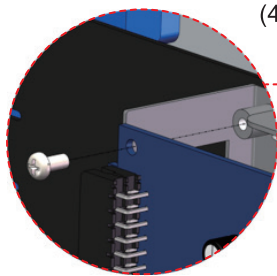

(4) M3x6mm Round Head Phillips Screw

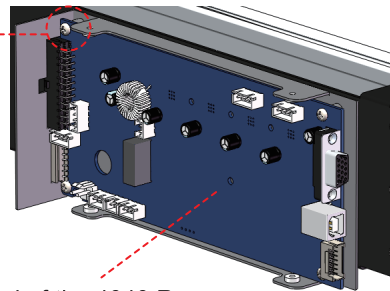

Control Board of the 4040 Reno

Install the Y-axis Extension Module

11. Plug the cables into the control board, as shown.
12. Connect the DC power cable terminal and fan cable terminals on the control board housing to the control board.

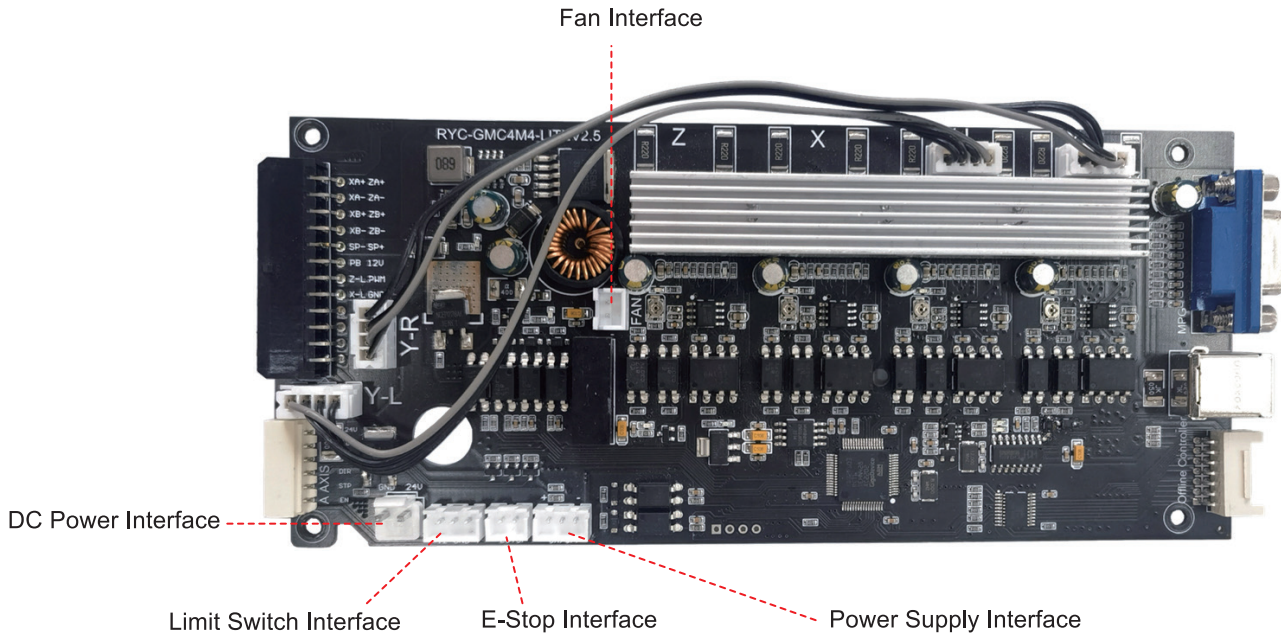

Install the Y-axis Extension Module

What you need in this step of the installation:



★ Sheet Metal Housing



★ M3 Gaskets



(4) M3x4mm Round Head Socket Screw

13. Use (4) M3x4mm round head socket screws with M3 gaskets and mount the sheet metal housing.

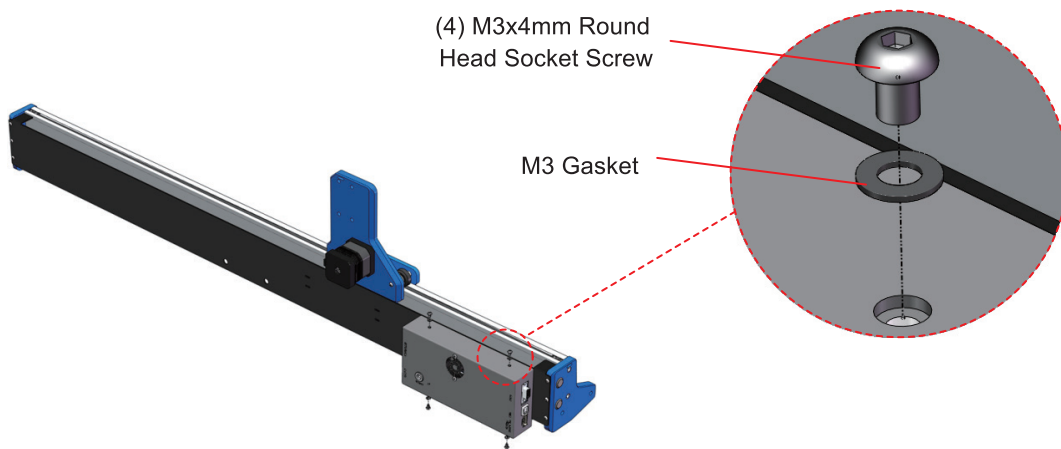



Install the Y-axis Extension Module

Step 2: Assemble the Y-axis Right Module

What you need in this step of the installation:



Customized Y-axis Right Profile L975mm
(Inside Belt L1133mm.)



★ Y-axis Right Assembly

Belt already secured at one end in the profile

1. Slide the YR left assembly into the YR profile. Motor terminals toward the unsecured end of the belt, as shown.

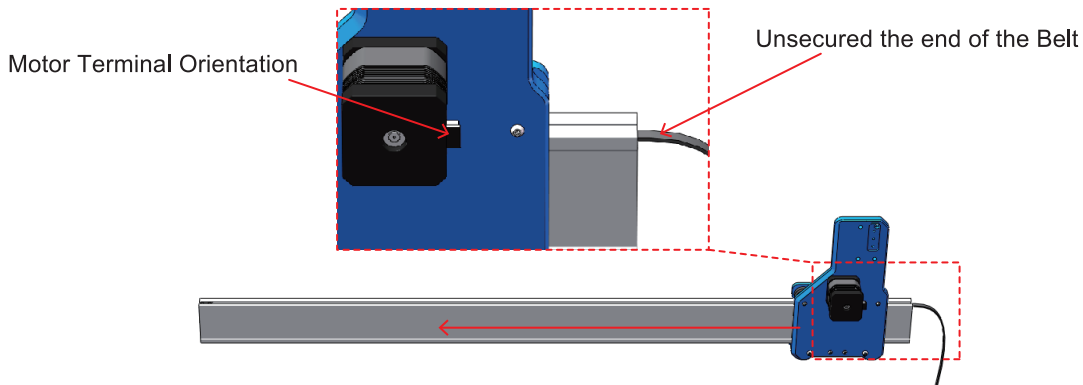



Install the Y-axis Extension Module

2. Pass the belt through the Y-axis right assembly as shown.

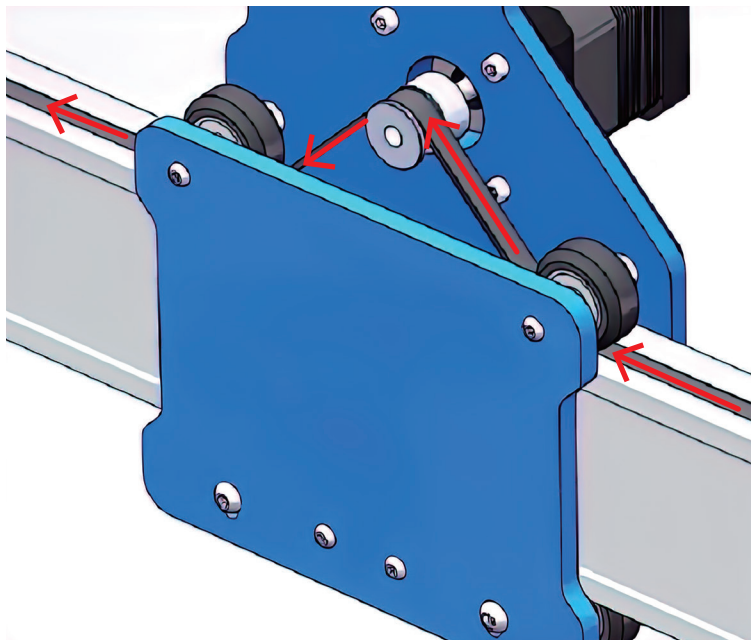



Install the Y-axis Extension Module

What you need in this step of the installation:



★ Belt Lever



★ Front Guard (Right)



★ Rear Guard (Right)



★ (4) M5 small cup head screws

3. Fit the belt lever into the profile from the unsecured end of the belt. Take care when fitting that the belt lever presses against the belt at the top of the belt.

4. Use (4) M5 small cup head screws to mount the YR module front and rear guards to the profile, as shown.

TIPS: 1. Pay attention to the front and rear guards mounting direction.

2. Note that the belt need to be threaded into the rear guard slot.

Unsecured the
end of the Belt

Rear Aluminum Baffle
with Belt Tensioner Slot

(4) M5 Small Cup
Head Screw

Belt Lever

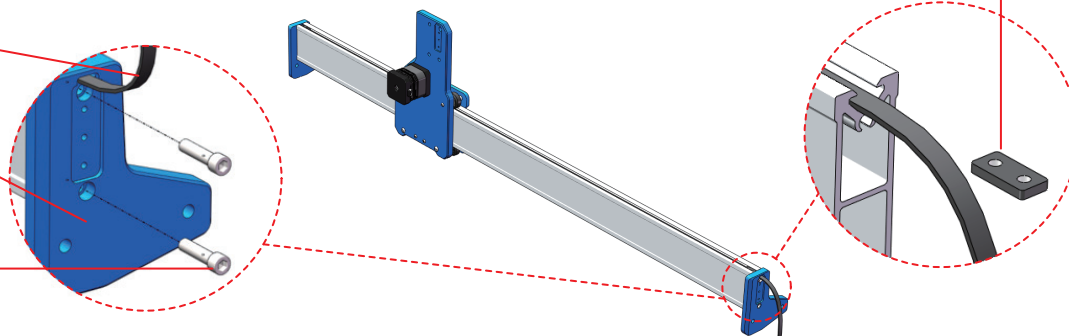

Install the Y-axis Extension Module

Step 3: Assemble the Belt Tensioner

(YL & YR operate identically and can be synchronized.)

What you need in this step of the installation:



★ Belt Tension Holder

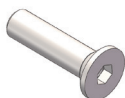

★ (3) M3x12mm Hex Socket
Flat Head Cap Screw

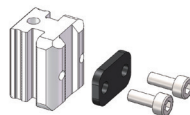

★ Belt Tensioner
Slider Block Kit



★ Slider Locating Screw

1. Use (3) M3x12mm hex socket flat head cap screws, through the belt tension holder and install it on the YR module vertical plate.
2. Install the belt tensioner slider block into the belt tension holder and make the top of the slider flush with the end of the slider locating screw.
3. Install the removed compression sheet metal onto the slider block, not lockable, leaving enough gap.

Install the Y-axis Extension Module

4. Fold the belt inward and press the smooth side of the belt against the dowel pin. Tighten the slider locating screw and the (2) sheet metal screw.

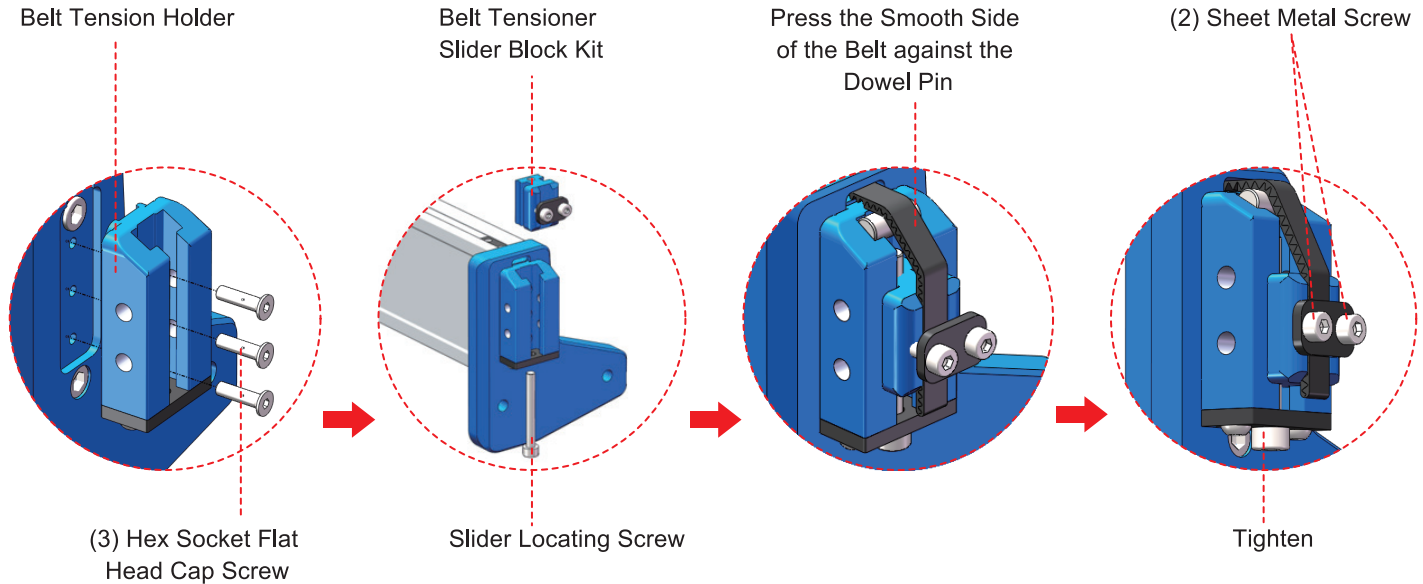

Install the Y-axis Extension Module

What you need in this step of the installation:



★ (4) Tightening Screws



(4) M3x6mm Round Head Phillips Screw

5. Lock the (4) tightening screws on both sides of the belt tensioner.

6. Use (2) M4x3mm flat hexagon socket set screws to screw into the belt lever to hold the belt in place. Slide the Z-axis module and feel the smooth movement of the module.

Note: Do not tighten the setscrews too much, there is a probability that the belt will be pressed off, and the belt tightness will be affected.

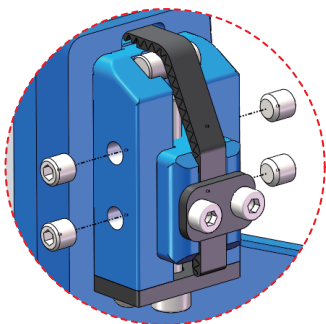

(4) Tightening Screw

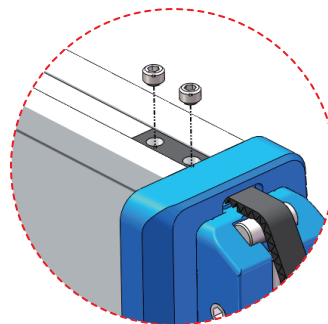

(2) M4x3mm Flat Hexagon
Socket Set Screw

Install the Y-axis Extension Module

Step 4: Assemble the Y-axis Platform Frame

What you need in this step of the installation:



(12) Internal Angle Connector
Joint Bracket (with M5 Set Screws)



(2) 2020 Long Profile L934mm



2020 Short Profile L399mm

1. Slide the (4) internal angle connector joint brackets into the short profile.
2. Slide the short profile into the middle position of the (2) long profiles, as shown.

Do not tighten the M5 set screws in the angle connector joint brackets on profiles.

3. Slide the (8) internal angle connector joint brackets into the (2) long profiles.



Install the Y-axis Extension Module

4. Slide the short profile into the middle position of the (2) long profiles, as shown. Pay attention to the orientation of the bottom profiles.

Do not tighten the M5 set screws in the Internal angle connector joint brackets on profiles.

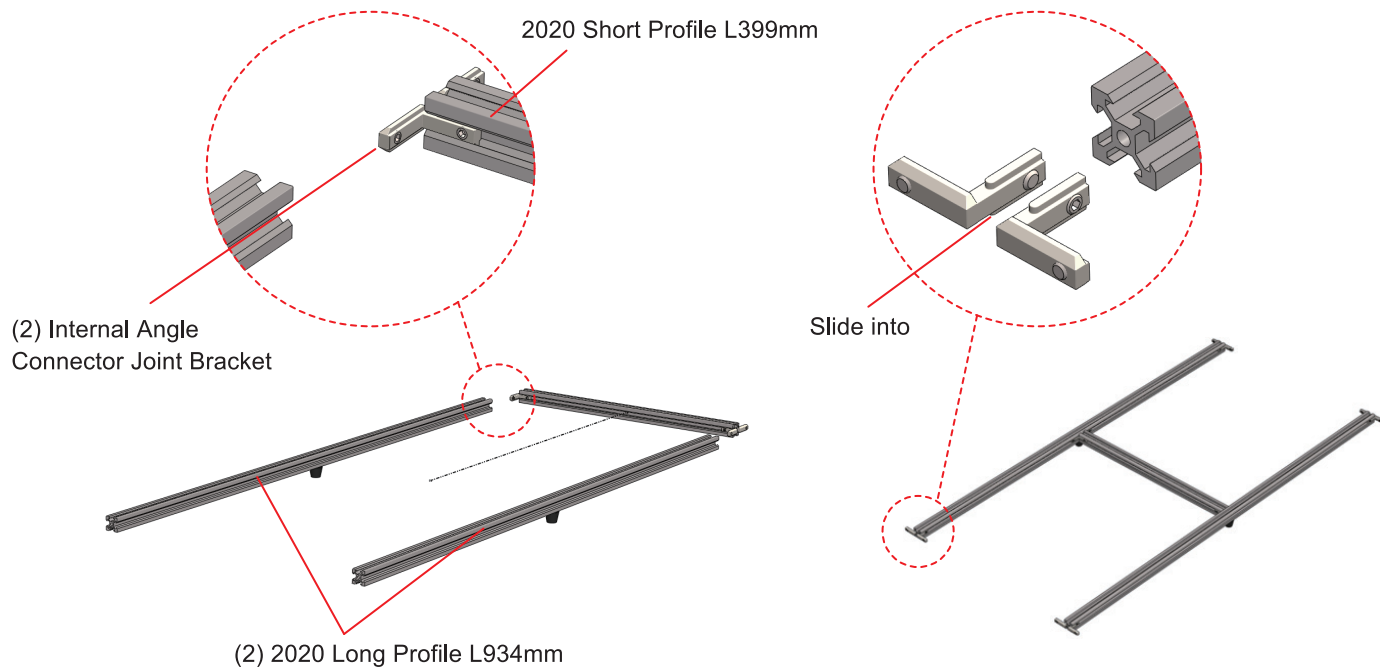



Install the Y-axis Extension Module

What you need in this step of the installation:



★ Bottom Profiles

- Slide the (2) bottom profiles into the ends of the (2) long profiles, as shown. Adjust the (2) long profiles to a position where the ends of the bottom profile are centered. Do not lock the set screws.

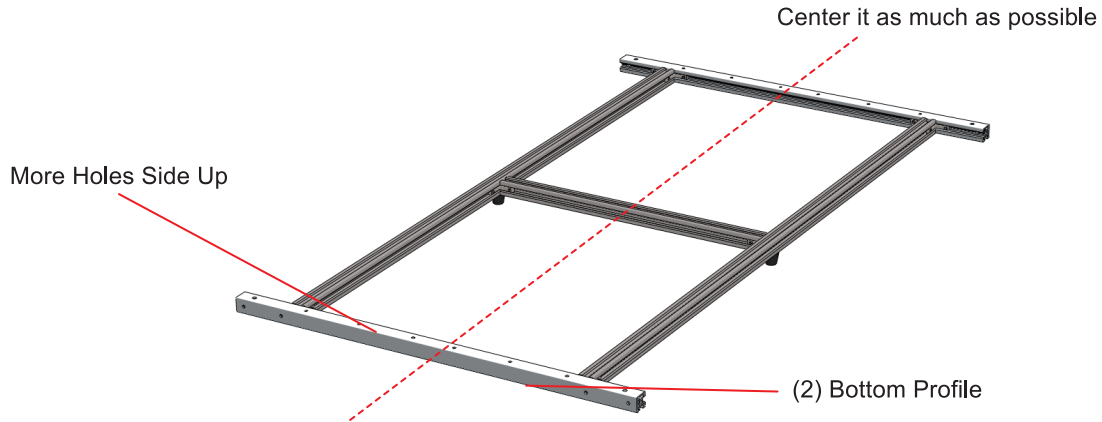



Install the Y-axis Extension Module

What you need in this step of the installation:



★ (4) M5 Small Cup Head Socket Screw

6. Adjust the position of the slider nut inside the YL&YR profiles.

7. Use (4) M5 small cup head socket screws, through the holes in the bottom profile and install them into the slider nuts on the bottom of the YL&YR profile.

TIP: Do not tighten the screws.

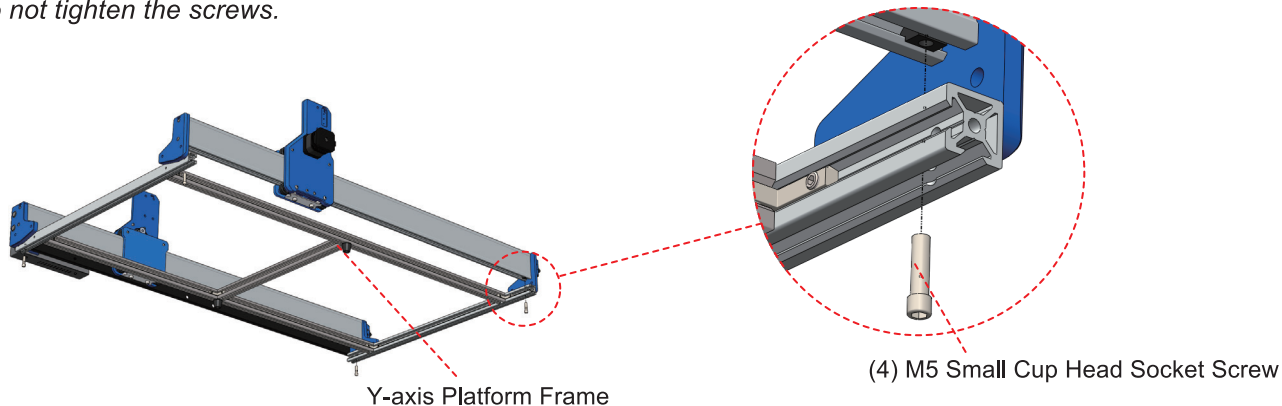



Install the Y-axis Extension Module

What you need in this step of the installation:



★ (8) M5 round head socket screws

8. Use (8) M5 round head socket screws to install bottom profile into the YL&YR front and rear guards. Tighten them after all screws have been screwed into the screw holes. Finally, tighten the M5 small cup head socket screws.

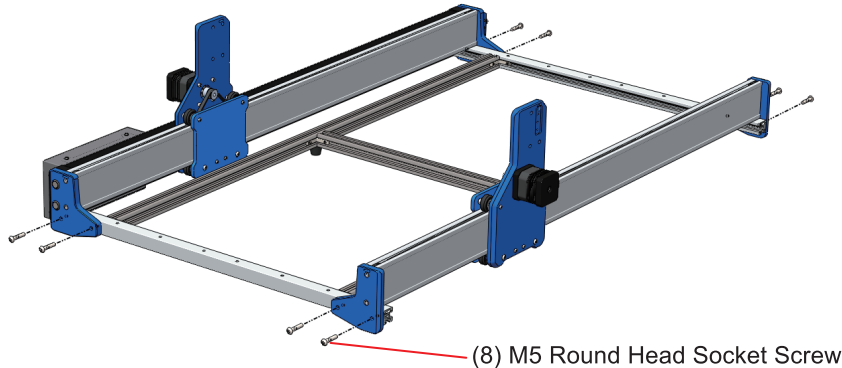

(8) M5 Round Head Socket Screw



Install the Y-axis Extension Module

9. At this point, check that the bottom support profile is roughly centered; if it is offset, adjust the (2) long profiles position again.
10. After confirming that it is roughly centered, lock the set screws in the (12) internal angle connector joint brackets on the bottom profile.

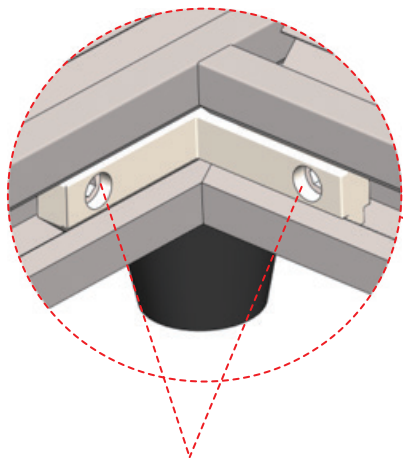

Tighten

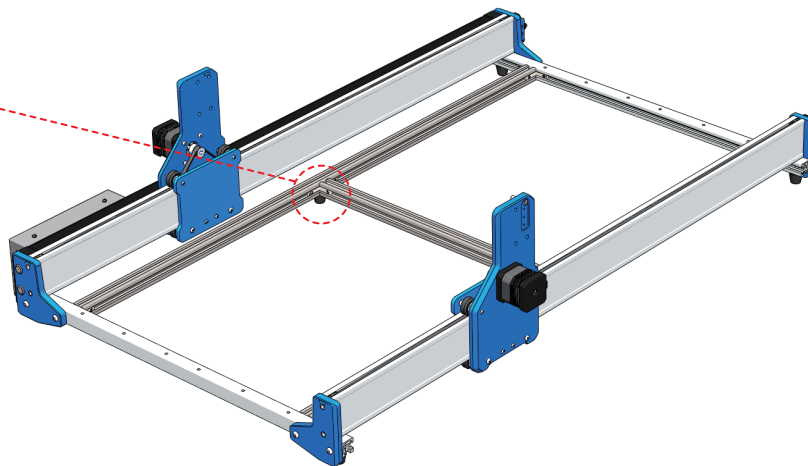

Install the Y-axis Extension Module

Step 5: Assemble the X-axis Module

What you need in this step of the installation:

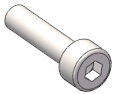

★ (1) M5 Small Cup Head
Hexagon Socket Screw



★ (7) M5 Round Head
Socket Screw

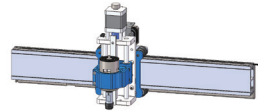

★ X-axis module

1. Before installing, the belt needs to be retracted into the X-axis profile.
2. Embed the X-Z module between the YL & YR vertical plates.
3. Pass the belt through the YR vertical plate slot.
4. Use (7) M5 round head socket screws and (1) M5 small cup head hexagon socket screw, through the YL & YR vertical plates to connect the X-axis module.

Install the Y-axis Extension Module

5. After screwing all the screws into the screw holes, tighten the screws in a cross pattern.

(7) M5 Round Head Socket Screw

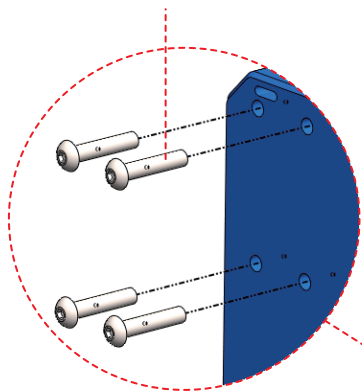

(1) M5 Small Cup Head Hexagon Socket Screw

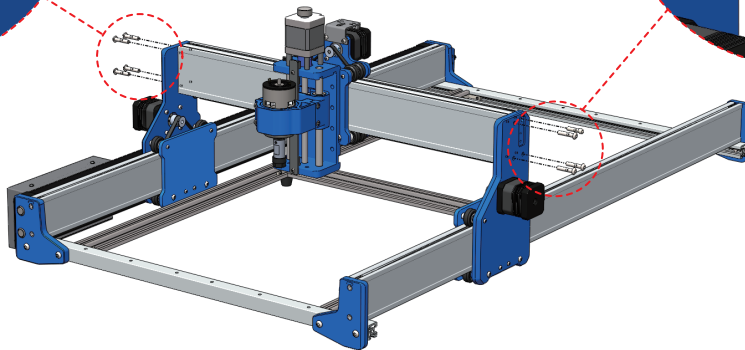
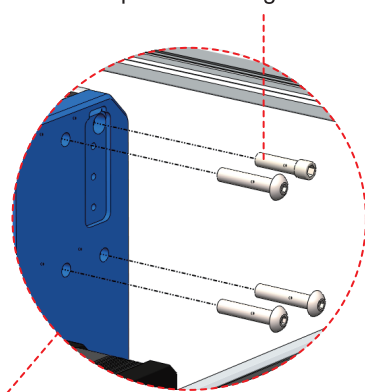



Install the Y-axis Extension Module

What you need in this step of the installation:



★ Belt Tension Holder

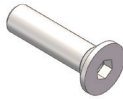

★ (3) M3x12mm Hex Socket
Flat Head Cap Screw

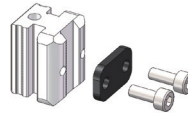

★ Belt Tensioner
Slider Block Kit



★ Slider Locating Screw

7. Use (3) M3x12mm hex socket flat head cap screws, through the belt tension holder and install it on the YR module vertical plate.
8. Install the belt tensioner slider block into the belt tension holder and make the top of the slider flush with the end of the slider locating screw.
9. Install the removed compression sheet metal onto the slider block, not lockable, leaving enough gap.

Install the Y-axis Extension Module

10. Fold the belt inward and press the smooth side of the belt against the dowel pin. Tighten the slider locating screw and the (2) sheet metal screws.

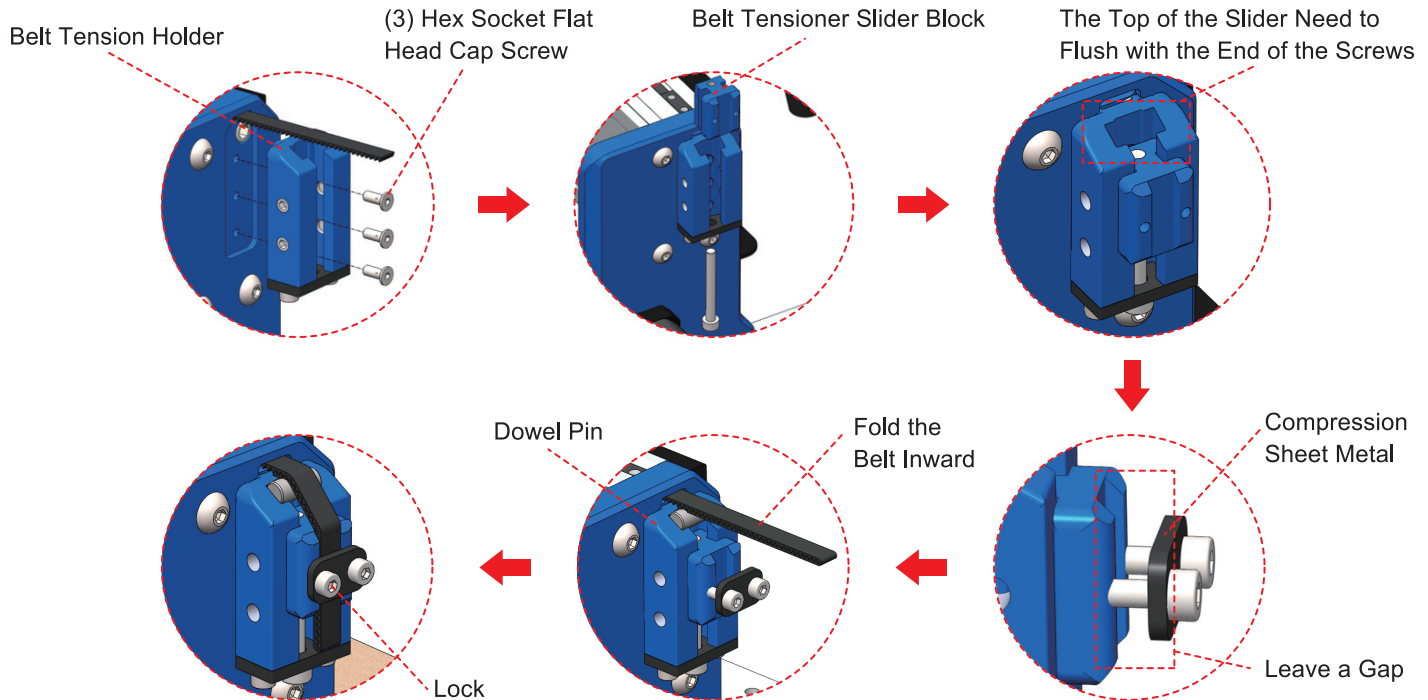

Install the Y-axis Extension Module

What you need in this step of the installation:



★ (4) Tightening Screws

(2) M4x3mm Flat Hexagon Socket Set Screw

11. Lock the (4) tightening screws on both sides of the belt tensioner.

12. Use (2) M4x3mm flat hexagon socket set screws to screw into the belt lever to hold the belt in place. Slide the Z-axis module and feel the smooth movement of the module.

Note: Do not tighten the setscrews too much, there is a probability that the belt will be pressed off, and the belt tightness will be affected.

(2) M4x3mm Flat Hexagon Socket Set Screw

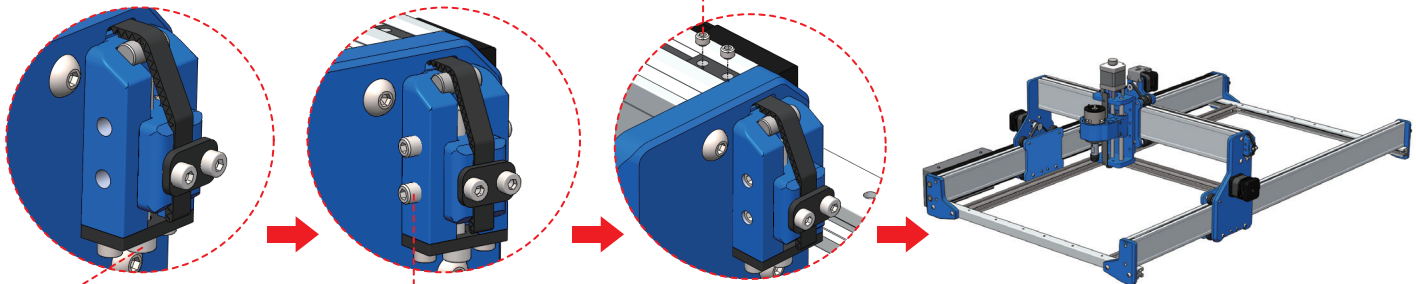

Tighten

(4) Tightening Screw



Install the Y-axis Extension Module

What you need in this step of the installation:



★ Rubber Feet



★ (4) M3 Cup Head Socket Screws

1. Use (4) M3 cup head socket screws to mount the rubber feet to the bottom profiles.

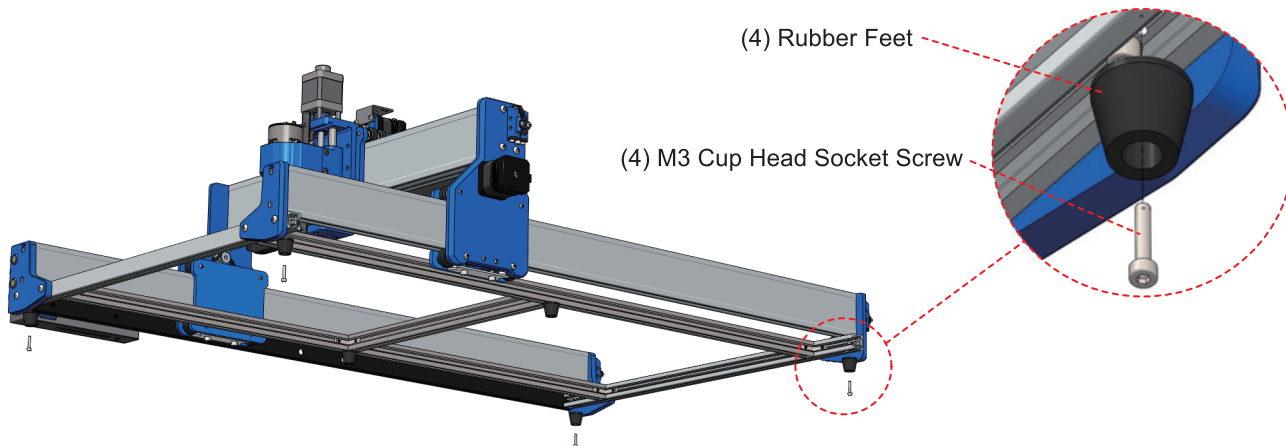



Finished

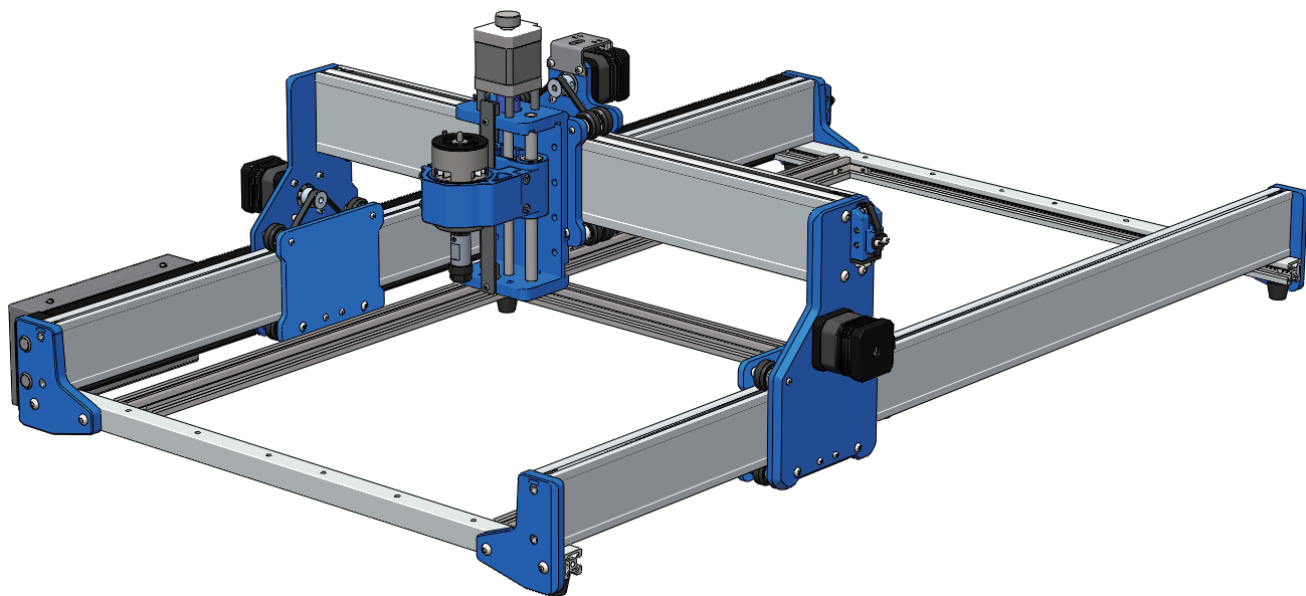

PART 3: Install the Hybrid Spoilboard

Select the platform plate to be installed according to your needs.



Unbox (101-63-40RENO-44HSP)

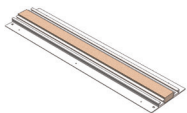

(3) Wide Aluminum & MDF Hybrid Slat

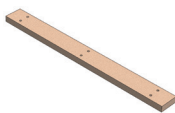

(2) Wide MDF Slat

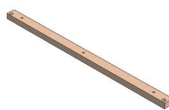

(2) Narrow MDF Slat



Allen Wrench
(2mm, 3mm, 4mm)



(5) M5x25mm Cup Head
Hexagon Socket Screw



(9) M5x20mm Thin Cup
Head Hexagon Socket Screw



(19) M3X14mm
Flat Head Cap Screw



User Manual



Install the 4040 Hybrid Spoilboard

Step 1: Remove the MDF Board

1. Use the 4mm Allen wrench to remove the screws from the MDF boards.
2. Remove the MDF boards after removing all the screws.

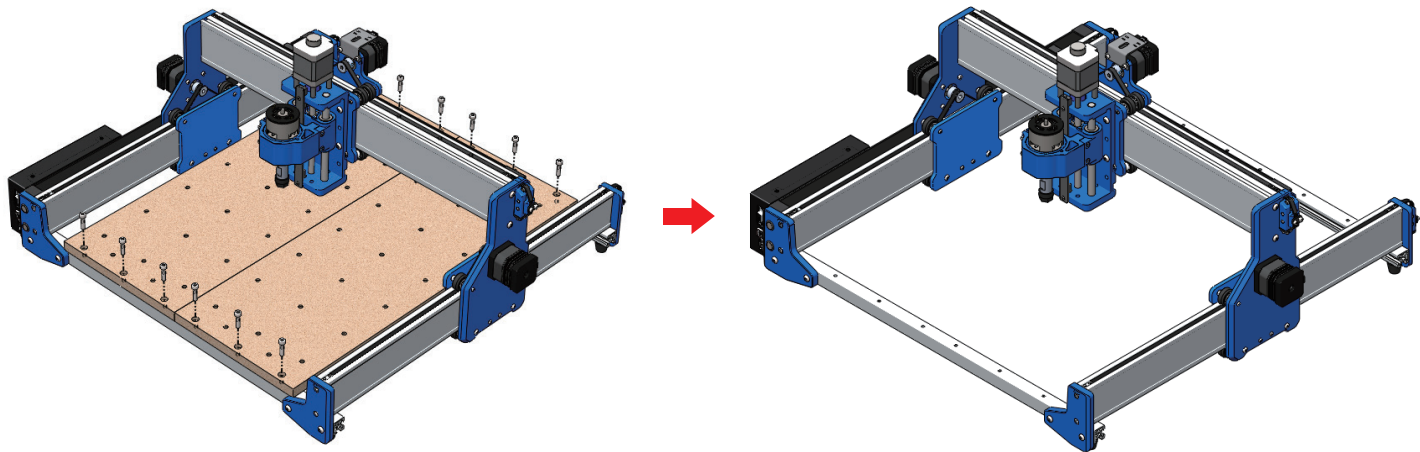

Install the 4040 Hybrid Spoilboard

Step 2: Install the 4040 Hybrid Spoilboard

What you need in this step of the installation:



(8) M5x20mm Thin Cup
Head Hexagon Socket Screw

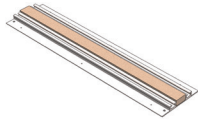

(3) Wide Aluminum
& MDF Hybrid Slat



3mm Allen Wrench

1. Screw the (8) M5x20mm thin cup head screws with the 4mm Allen wrench, through the wide aluminum & MDF hybrid slat holes into the bottom profiles.

Do not tighten at this time.

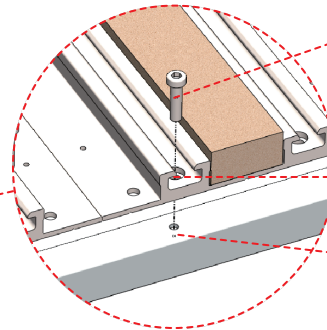
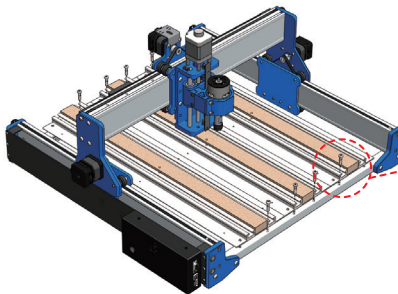

(8) M5x20mm Thin Cup
Head Hexagon Socket Screw

Aluminum Slat Screw Holes

Screw Holes on the Profile

Install the 4040 Hybrid Spoilboard

What you need in this step of the installation:

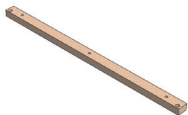

(2) Narrow MDF Slat



(4) M5x25mm Cup Head Hexagon Socket Screw



4mm Allen Wrench

2. Align the narrow MDF slats with the aluminum slat screw holes as shown.

Note: MDF slat countersunk screw holes up.

3. Screw the (4) M5x25mm cup head screws with the 4mm Allen wrench, through the narrow MDF slats countersunk holes into the aluminum slats.

Do not tighten at this time.

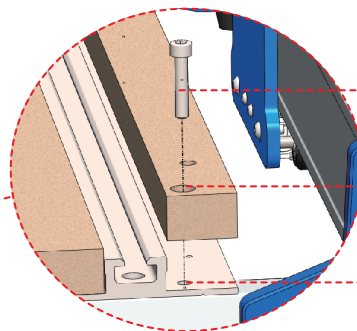
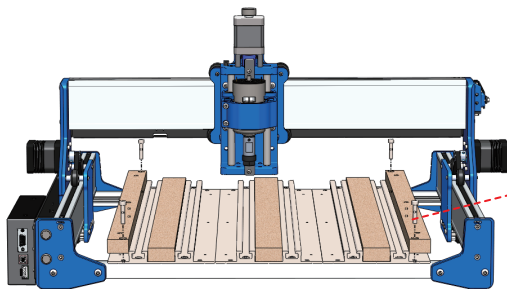

(4) M5x25mm Cup Head
Socket Screws

Countersunk Screw Holes

Screw Holes of Aluminum
& MDF Hybrid Slat



Install the 4040 Hybrid Spoilboard

What you need in this step of the installation:

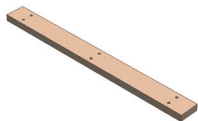

(2) Wide MDF Slat



(18) M3X14mm
Flat Head Cap Screw



Allen Wrench
(2mm, 3mm, 4mm)

4. Align the wide MDF slats with the aluminum slat screw holes as shown.

Note: MDF slat countersunk screw holes up.

5. Screw the (18) M3x14mm flat head cup screws with the 2mm Allen wrench, through the wide & narrow MDF slats countersunk holes into the aluminum slats, as shown.

Do not tighten at this time.

6. Tighten the (8) M5x20mm thin cup head socket screws (installed in the first step) on wide aluminum & MDF hybrid slats.

7. Tighten the (4) M5x25mm cup head screws (installed in the third step) on the narrow MDF boards.

Install the 4040 Hybrid Spoilboard

8. Tighten the (24) M3x14mm flat head cup screws, and finish assembly.

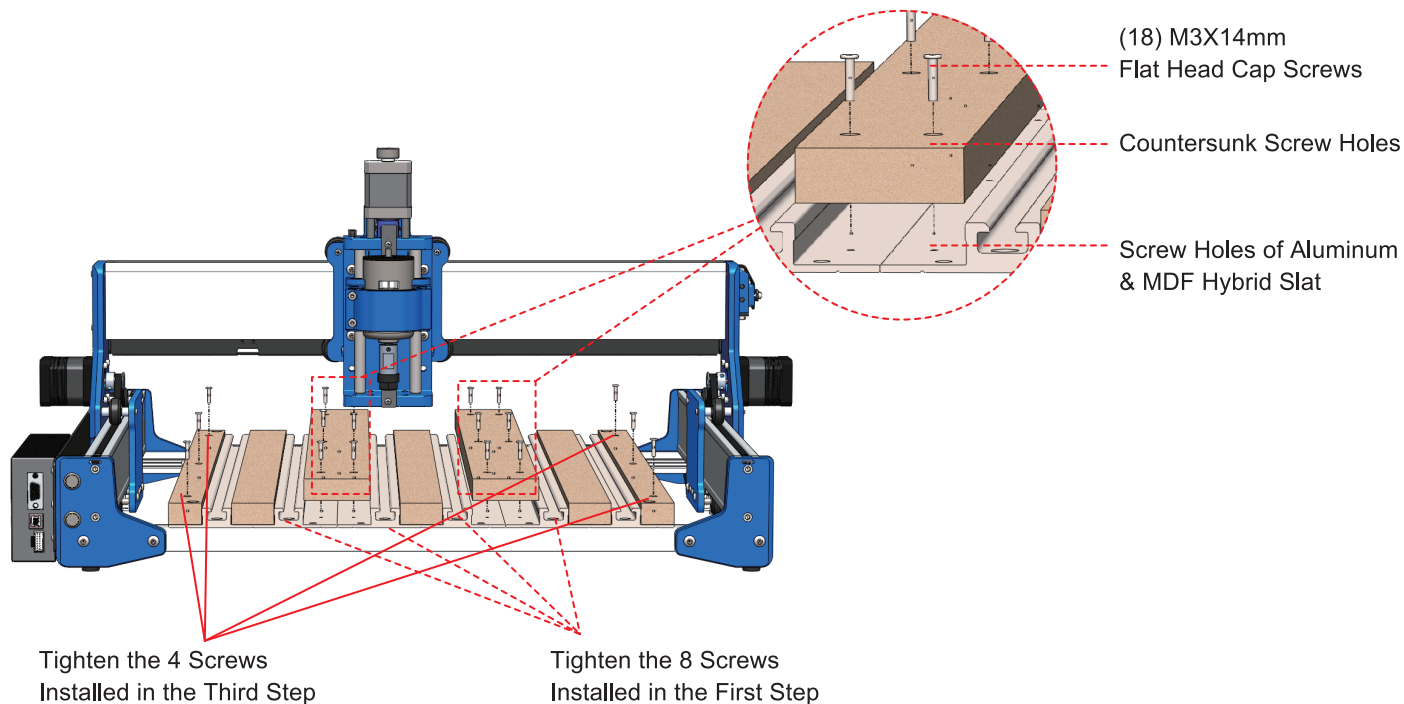



Unbox (101-63-40RENO-X64HSP)

For only X-axis expansion.

Needs to be used with 101-63-40RENO-HSP4040.

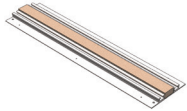

Wide Aluminum
& MDF Hybrid Slat



(2) Narrow Aluminum Slat

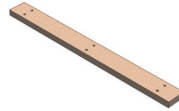

Wide MDF Slat

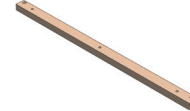

(2) Narrow MDF Slat



(13) M3X14mm
Flat Head Cap Screw



(9) M5x20mm Thin Cup
Head Hexagon Socket Screw



Allen Wrench
(2mm, 3mm, 4mm)



User Manual

Install the 6040 Hybrid Spoilboard

What you need in this step of the installation:



(16) M5x20mm Thin Cup
Head Hexagon Socket Screw
8 of them from 44HSP

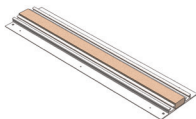

(4) Wide Aluminum
& MDF Hybrid Slats
8 of them from 44HSP



3mm Allen Wrench

1. Align the with the aluminum slat screw holes as shown.
2. Screw the (16) M5x20mm cup head screws with the 3mm Allen wrench, through the wide aluminum & MDF hybrid slats countersunk holes into the bottom profiles.

Do not tighten at this time.

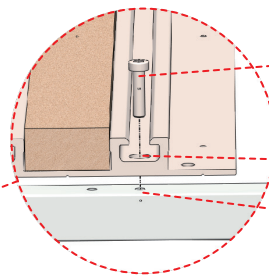
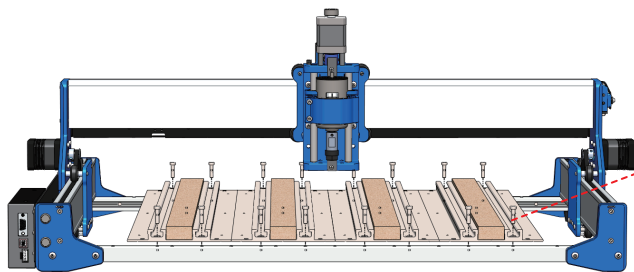

(16) M5x20mm Thin Cup
Head Hexagon Socket Screw

Aluminum Slats Screw Holes

Screw Holes on the Profile

Install the 6040 Hybrid Spoilboard

What you need in this step of the installation:

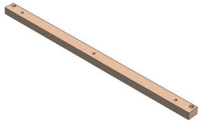

(4) Narrow MDF Slat
2 of them from 44HSP



(2) Narrow Aluminum Slat



(4) M5x25mm Cup Head
Hexagon Socket Screw
All of them from 44HSP



4mm Allen Wrench

3. Align the narrow MDF slats screw holes with the aluminum slats screw holes as shown.

Note: MDF slat countersunk screw holes up.

4. Screw the (4) M5x25mm cup head screws with the 4mm Allen wrench, through the narrow MDF slats countersunk holes and aluminum slats into the bottom profiles, as shown.

Do not tighten at this time.

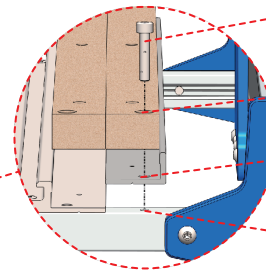
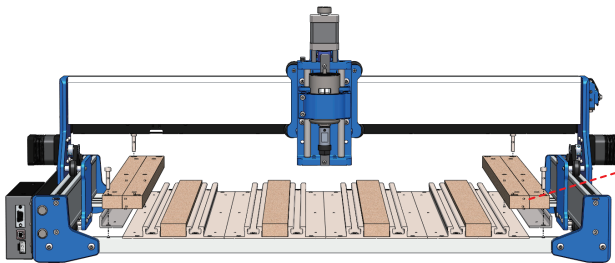

(4) M5x25mm Cup Head
Socket Screw

Countersunk Screw Holes

Screw Holes of the Wide
Aluminum & MDF Hybrid Slat

Screw Holes of the Narrow
Aluminum Slat



Install the 6040 Hybrid Spoilboard

What you need in this step of the installation:

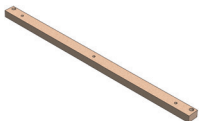

(4) Narrow MDF Slat
2 of them from 44HSP



(2) Narrow Aluminum Slat



(4) M5x25mm Cup Head
Hexagon Socket Screw
All of them from 44HSP



4mm Allen Wrench

5. Align the (3) wide MDF slats with the aluminum slat screw holes as shown.

Note: MDF slat countersunk screw holes up.

6. Screw the (30) M3x14mm flat head cup screws with the 2mm Allen wrench, through the wide & narrow MDF slats countersunk holes into the aluminum slats, as shown.

Do not tighten at this time.

7. Tighten the (16) M5x20mm thin cup head socket screws (installed in the second step) on wide aluminum & MDF hybrid slats.

8. Tighten the (4) M5x25mm cup head screws (installed in the fourth step) on the narrow MDF boards.



Install the 6040 Hybrid Spoilboard

9. Tighten the (30) M3x14mm flat head cup screws, and finish assembly.

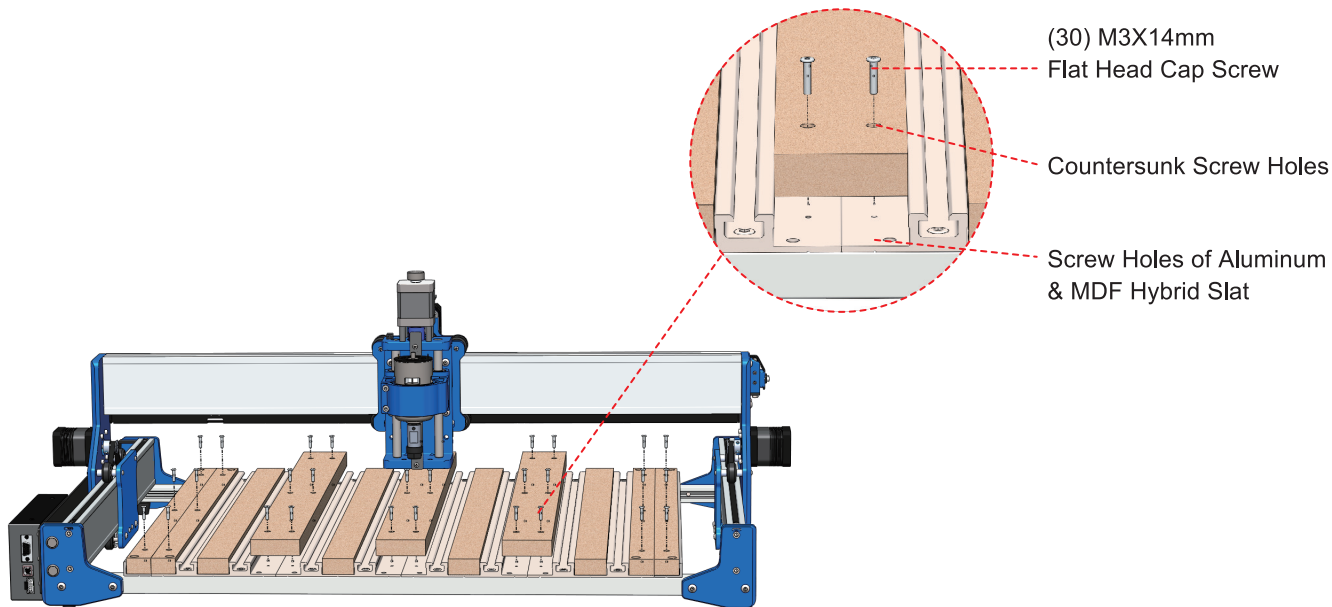

Tighten the 4 Screws
Installed in the Fourth Step

Tighten the 16 Screws
Installed in the Second Step



Unbox (101-63-40RENO-Y48HSP)

For only Y-axis expansion.

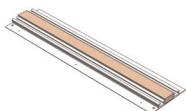

(3) Wide Aluminum & MDF Hybrid Slat

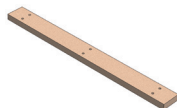

(2) Wide MDF Slat

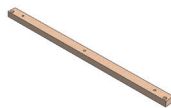

(2) Narrow MDF Slat



Allen Wrench
(2mm, 3mm, 4mm)



(5) M5x25mm Cup Head
Hexagon Socket Screw



(9) M5x20mm Thin Cup
Head Hexagon Socket Screw



(25) M3X14mm
Flat Head Cap Screw



User Manual



Install the 4080 Hybrid Spoilboard

What you need in this step of the installation:

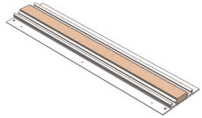

(3) Wide Aluminum & MDF Hybrid Slat



(8) M5x20mm Thin Cup Head Hexagon Socket Screw



3mm Allen Wrench

1. Align the with the aluminum slat screw holes as shown.
2. Screw the (8) M5x20mm cup head screws with the 3mm Allen wrench, through the wide aluminum & MDF hybrid slats countersunk holes into the bottom profiles.

Do not tighten at this time.

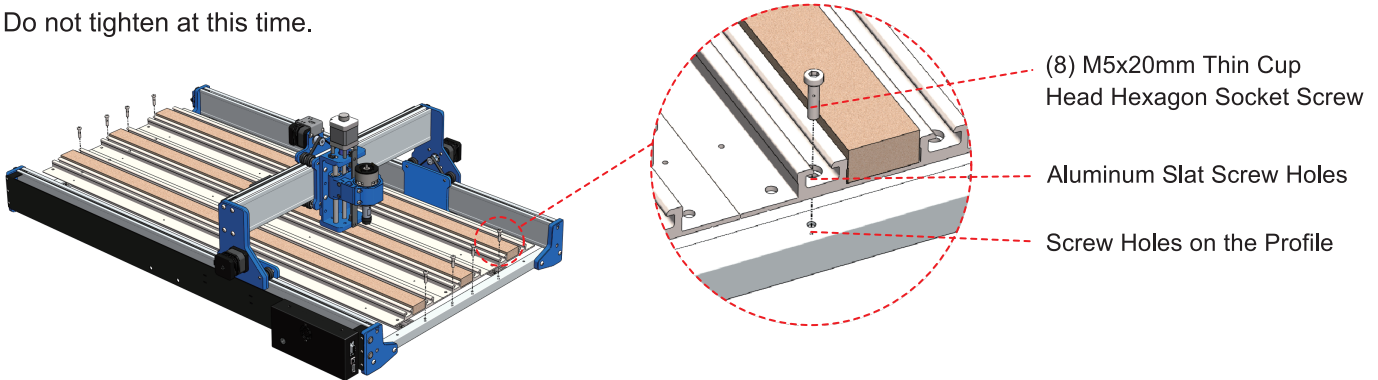

Install the 4080 Hybrid Spoilboard

What you need in this step of the installation:

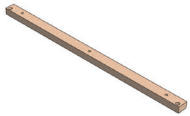

(2) Narrow MDF Slat



(4) M5x25mm Cup Head Hexagon Socket Screw



4mm Allen Wrench

3. Align the narrow MDF slats screw holes with the aluminum slats screw holes as shown.

Note: MDF slat countersunk screw holes up.

4. Screw the (4) M5x25mm cup head screws with the 4mm Allen wrench, through the narrow MDF slats countersunk holes and aluminum slats into the bottom profiles, as shown.

Do not tighten at this time.

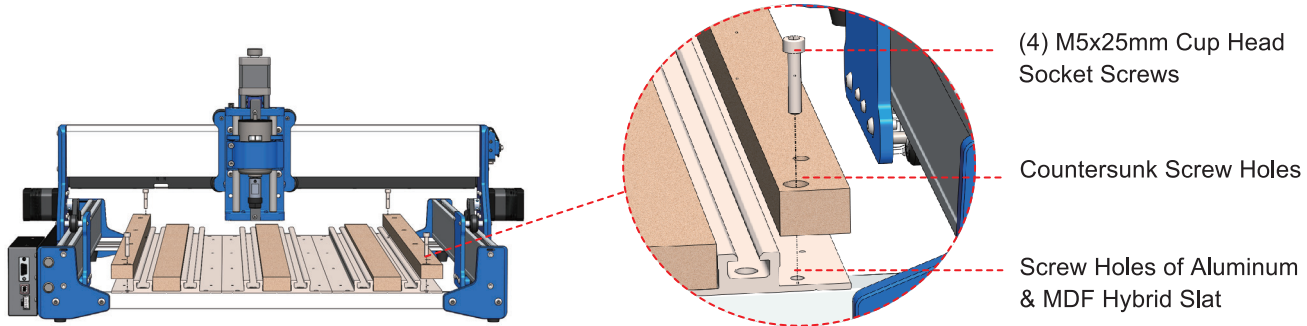

Install the 4080 Hybrid Spoilboard

What you need in this step of the installation:

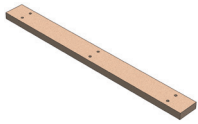

(2) Wide MDF Slat



(24) M3X14mm
Flat Head Cap Screw



Allen Wrench
(2mm, 3mm, 4mm)

5. Align the wide MDF slats with the aluminum slat screw holes as shown.

Note: MDF slat countersunk screw holes up.

6. Screw the (24) M3x14mm flat head cup screws with the 2mm Allen wrench, through the wide & narrow MDF slats countersunk holes into the aluminum slats, as shown.

Do not tighten at this time.

7. Tighten the (8) M5x20mm thin cup head socket screws (installed in the second step) on wide aluminum & MDF hybrid slats.

8. Tighten the (4) M5x25mm cup head screws (installed in the fourth step) on the narrow MDF boards.

Install the 4080 Hybrid Spoilboard

8. Tighten the (18) M3x14mm flat head cup screws, and finish assembly.

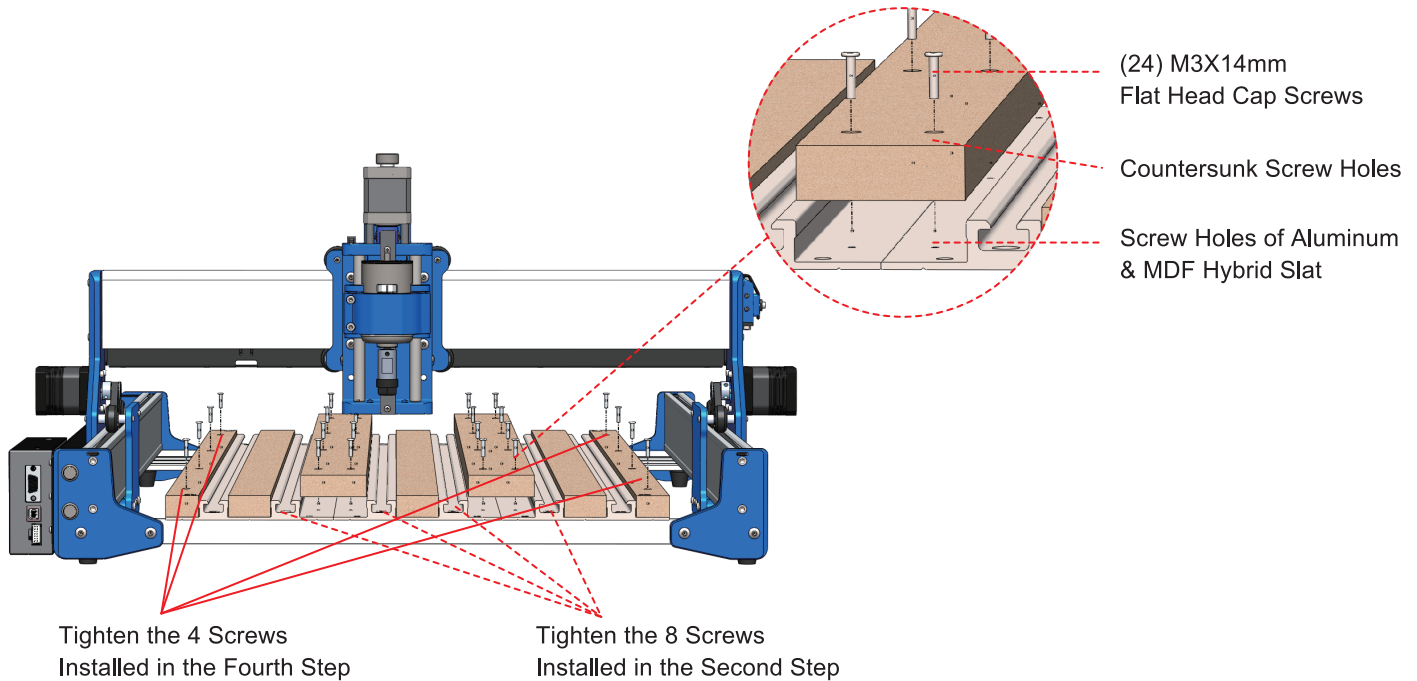



Unbox (101-63-40RENO-68HSP)

Needs to be used with 101-63-40RENO-68HSP.

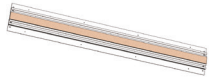

Wide Aluminum
& MDF Hybrid Slat



(2) Narrow Aluminum Slat

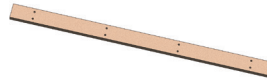

(3) Wide MDF Slat



Allen Wrench (2mm, 3mm)



(17) M3X14mm
Flat Head Cap Screw



(9) M5x20mm Thin Cup
Head Hexagon Socket Screw



User Manual

Install the 6080 Hybrid Spoilboard

What you need in this step of the installation:



(16) M5x20mm Thin Cup
Head Hexagon Socket Screw
8 of them from 48HSP

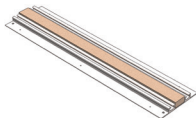

(4) Wide Aluminum
& MDF Hybrid Slat
3 of them from 48HSP



3mm Allen Wrench

1. Align the with the aluminum slat screw holes as shown.
2. Screw the (16) M5x20mm cup head screws with the 3mm Allen wrench, through the wide aluminum & MDF hybrid slats countersunk holes into the bottom profiles.

Do not tighten at this time.

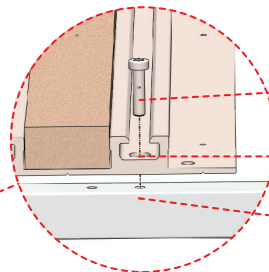
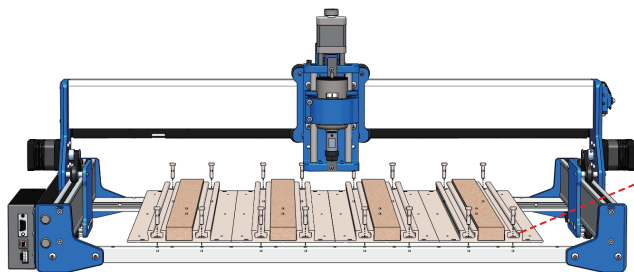

- (16) M5x20mm Thin Cup
Head Hexagon Socket Screw
- Aluminum Slat Screw Holes
- Screw Holes on the Profile



Install the 6080 Hybrid Spoilboard

What you need in this step of the installation:

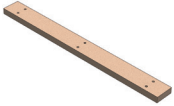

(3) Wide MDF Slat

3. Align the wide MDF slats screw holes with the aluminum slats screw holes as shown.

Note: MDF slat countersunk screw holes up.

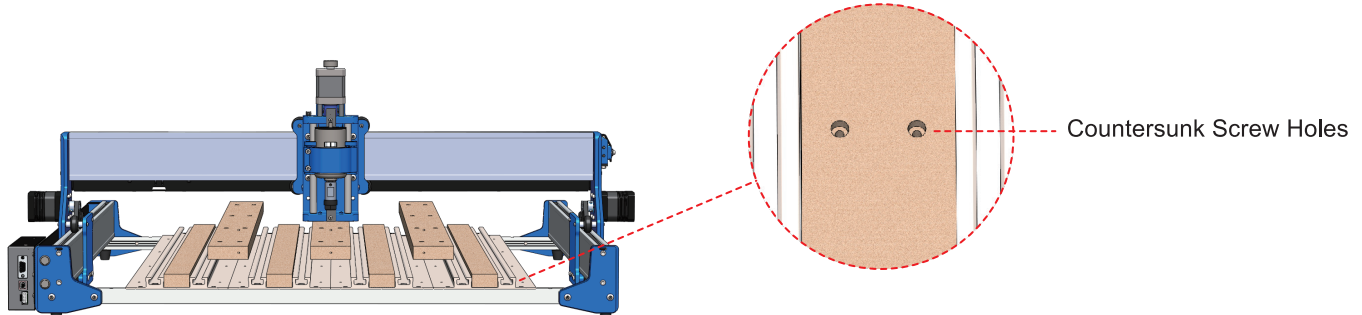



Install the 6080 Hybrid Spoilboard

What you need in this step of the installation:



(2) Narrow Aluminum Slats

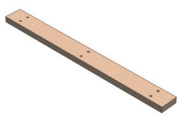

(2) Wide MDF Slats
All of them from 48HSP



(40) M3X14mm
Flat Head Cap Screw
24 of them from 48HSP



Allen Wrench
(2mm, 3mm)

4. Place the (2) narrow aluminum slat on both sides of the bottom profiles, then place the (2) wide MDF slats as shown.

Note: MDF slat countersunk screw holes up.

5. Screw the (40) M3x14mm flat head cup screws with the 2mm Allen wrench, through the wide MDF slats countersunk holes into the aluminum slats as shown.

Do not tighten at this time.

6. Tighten the (16) M5x20mm thin cup head socket screws (installed in the second step) on wide aluminum & MDF hybrid slats.



Install the 6080 Hybrid Spoilboard

7. Tighten the (40) M3x14mm flat head cup screws, and finish assembly.

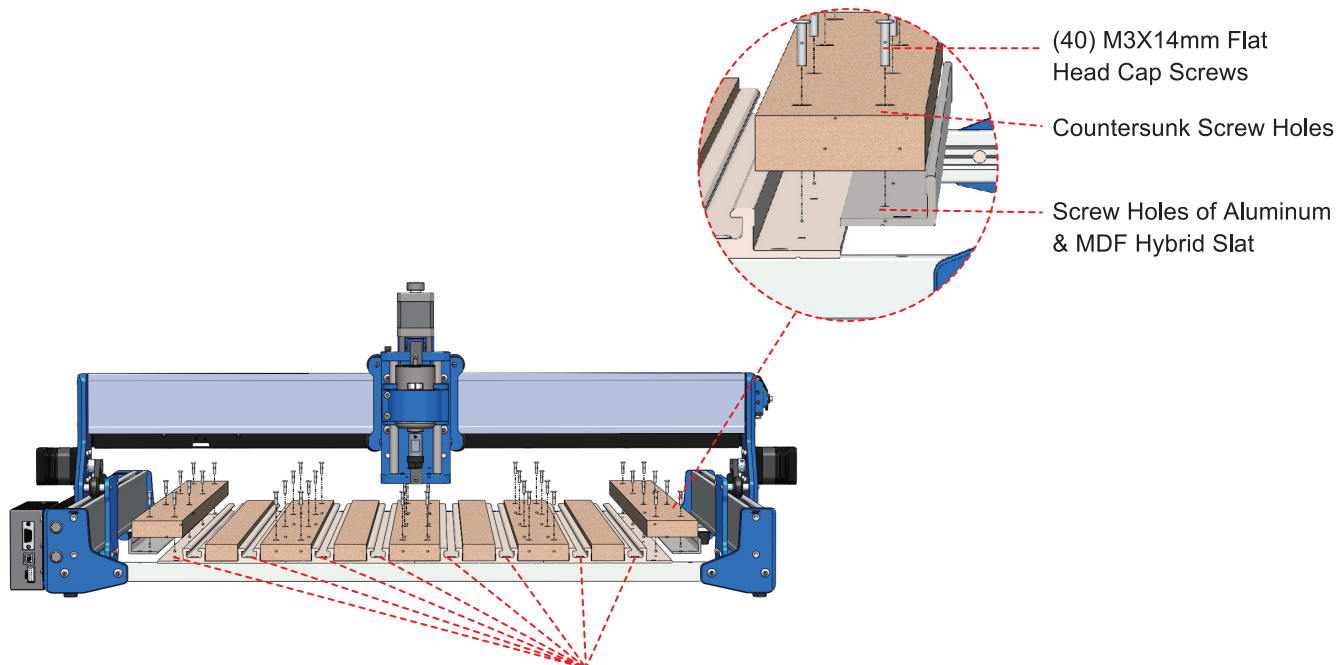

(40) M3X14mm Flat Head Cap Screws

Countersunk Screw Holes

Screw Holes of Aluminum & MDF Hybrid Slat

Tighten the 16 Screws Installed in the Second Step



Genmitsu

Desktop CNC & Laser

✉ Email: support@sainsmart.com

📘 Facebook messenger: <https://www.facebook.com/SainSmart/about>

Help and support is also available from our Facebook Group

2330 Paseo Del Prado, C303, Las Vegas, NV 89102



Facebook Group